

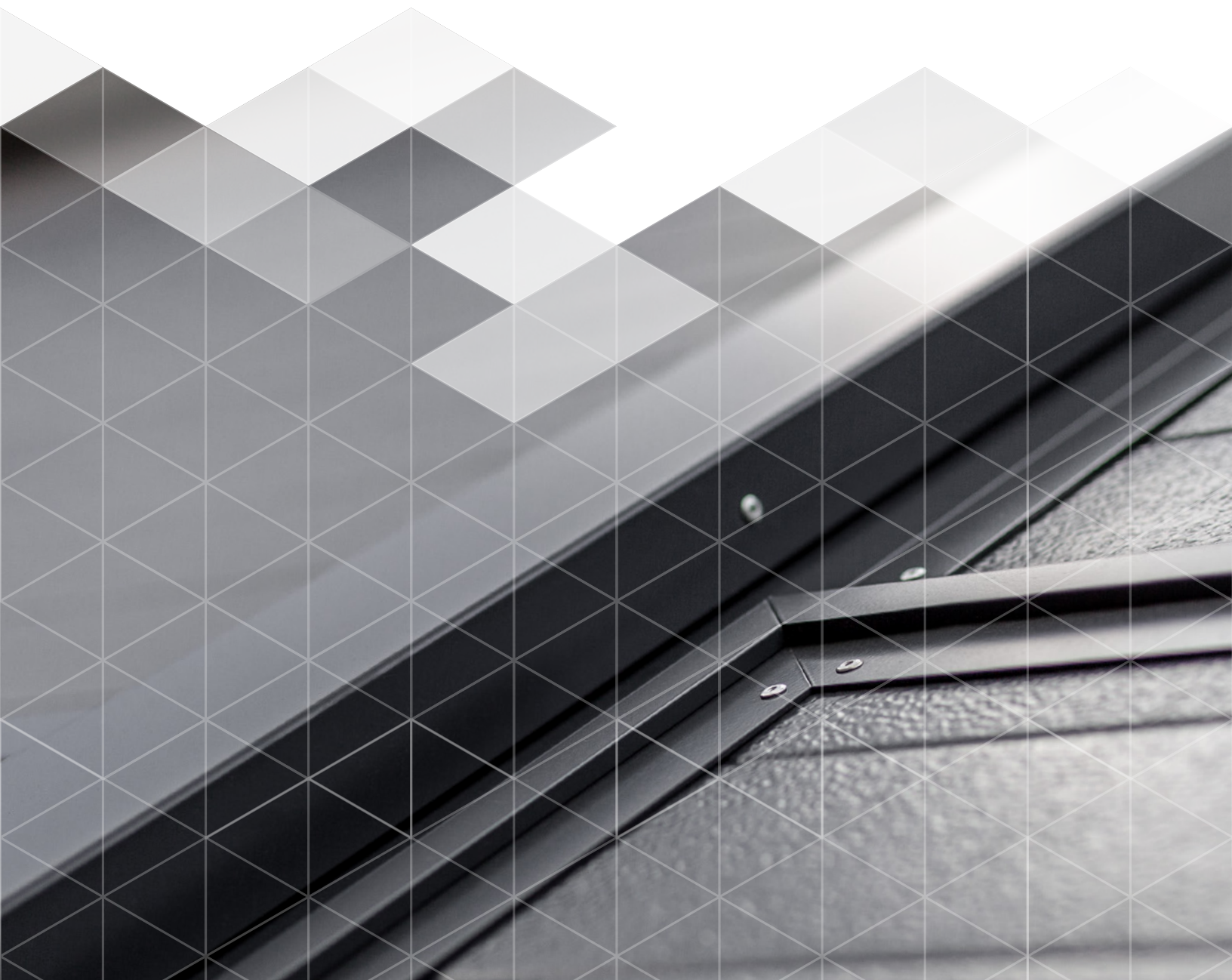

Catálogo de Accesorios y Molduras | Accessories and Trims Catalog



Tornillería y Fijación - Fasteners and Fixing

Tornillería FM - FM Screws and Fasteners

Tornillos Bimetalicos Autotaladrantes de Acero Inoxidable | Stainless Steel Bi-Metal Self Drilling Screw

Grado 304 - Grade 304 (JT3-D-6H-5.5/6.3 x 87 - E16)



Grado 304 - Grade 304 (JT3-D-6H-5.5/6.3 x 107 - E16)



Grado 304 - Grade 304 (JT3-D-6H-5.5/6.3 x 127 - E16)



Grado 304 - Grade 304 (JT3-D-6H-5.5/6.3 x 147 - E16)



Grado 304 - Grade 304 (JT3-D-6H-5.5/6.3 x 197 - E16)



Grado 304 - Grade 304 (JT3-D-6H-5.5/6.3 x 237 - E16)



Grado 304 - Grade 304 (JT3-D-6H-5.5/6.3 x 267 - E16)



Grado 304 - Grade 304 (JT3-2H 4.8 x 19 - E16)



Grado 304 - Grade 304 (JT3-6-5.5x50 - E16)



Pija - Screw-in Pin # 8x½ K-LATHE S/A



Tornillería Estandar - Standard Screws and Fasteners

Pija Autotaladrante | Self Drilling Screw

MA # 14X1" S/A



MA # 14X1-1/4" S/A



MA # 14X1-1/2" S/A



MA # 14X 2" S/A



MA # 14X 2 1/2" S/A



MA # 14X 3" S/A



MA # 14X 4" S/A



MA # 14X 5" S/A



MA # 14X 6" S/A



MA # 14X 8" S/A



MA # 14X 10" S/A



Arandela galvanizada - Galvanized Washing Ring #14X15



Otros Tornillos | Other Fasteners and Screws

Varilla Roscada Galvaniada de ¾"
¾" Galvanized Threaded Rod



Tuerca Cople Galvanizada de ¾"
¾" Galvanized Coupling Nut



Tornillo Cabeza Coche Galvanizado de ¾"
¾" Carriage Bolt



Complementos - Installation Complements

Liner Clip - Clip de fijación tipo "z"

| Description | Descripción | Especificación | Especificación |
|----------------|---------------------|----------------|----------------|
| 3" fixing clip | Clip de fijación 3" | Gauge 14 | Calibre 14 |

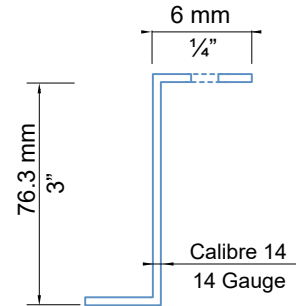
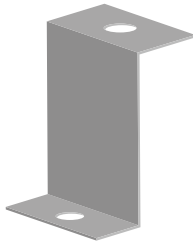

T-Bar system - Perfil "T" de suspensión

| Description | Descripción | Linear length 13 ft - Longitud lineal 4 m |
|--------------------------------------|--|---|
| Fiberglass t-bar Polyester finish | Perfil "T" en fibra de vidrio Acabado poliéster | |

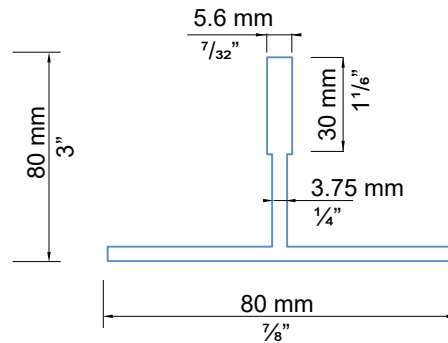
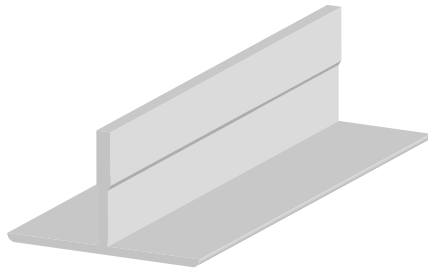

T-Bar system - Perfil "T" de suspensión

| Description | Descripción | Linear length 13 ft - Longitud lineal 4 m |
|--------------------------------------|--|---|
| Fiberglass t-bar Polyester finish | Perfil "T" en fibra de vidrio Acabado poliéster | |

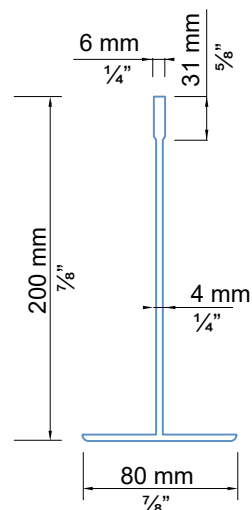
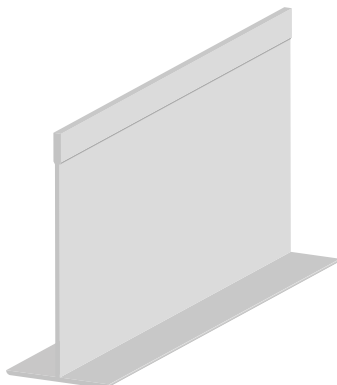

Complementos - Installation Complements

Beam clamp - Orquilla de fijación

| Description | Descripción |
|----------------------|--------------------------|
| Galvanized M10 clamp | Orquilla M10 galvanizada |

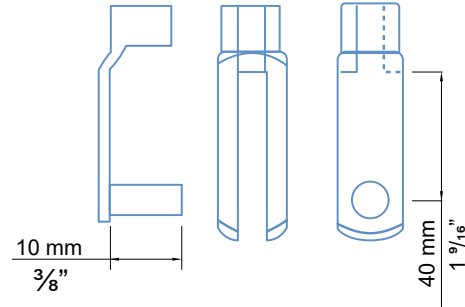

M10 Bolt - Bulon M10

| Description | Descripción |
|----------------------|--------------------------|
| Galvanized M10 clamp | Orquilla M10 galvanizada |

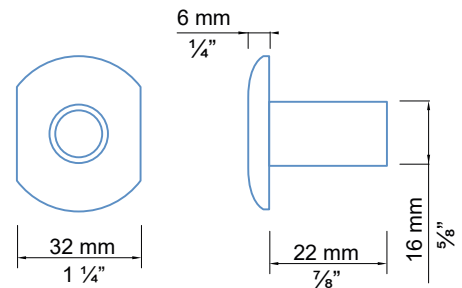
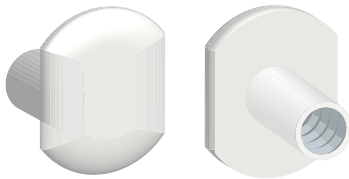

Complementos - Installation Complements

2 3/8" Washer - Arandela de 60mm

| Description | Descripción |
|-------------------------|------------------------|
| For TEC 164 and TEC 166 | Para TEC 164 y TEC 166 |

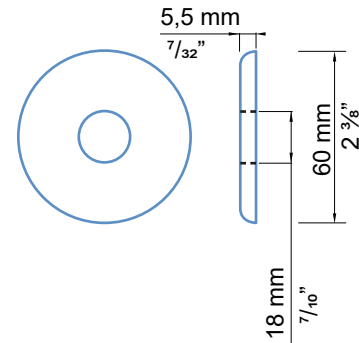

Door casing - Moldura para puerta

| Description | Descripción |
|--------------------------------------|--|
| Fiberglass t-bar Polyester finish | Perfil "T" en fibra de vidrio Acabado poliéster |

Linear working length 10 ft - Long. de trabajo 3.05 m lineales

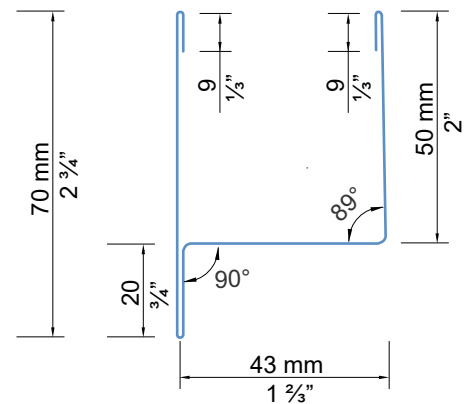
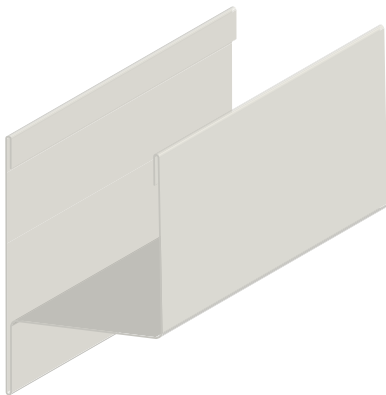

Complementos - Installation Complements

Capelloti Isocop - Isocop fastening clip



Para Panel Isocop - For Isocop Panel

| Code - Código | Material |
|---------------|---|
| | Acero Galvanizado - Galvanized Steel |
| | Acero RAL 9010 / 9002 - RAL Color 9010 / 9002 Steel |
| 51000010 | Terracota |

Soporte metálico para panel Isoparete - Metal panel support for Isoparete



| Code - Código | Dimensiones - Dimensions | Material |
|---------------|--|---------------------------------------|
| 510000310 | 80 x 24 x 2 mm 3 1/8 x 1" x 5/64 mm | Acero Galvanizado Galvanized Steel |
| 5100003104 | 80 x 24 x 2 mm (2 barrenos) 3 1/8 x 1" x 5/64 mm (2 drill bits) | Acero Galvanizado Galvanized Steel |

- Diseñado para isoparete plissé. Diámetro de barreno 7mm
- Designed for striated isoparete. Drill hole diameter 1/4"

Cinta de butilo - Butyl tape

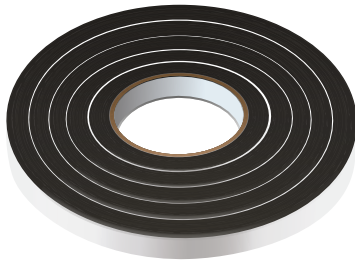

| Code - Código | Dimensiones - Dimensions |
|---|----------------------------------|
| 12420000 | 6 x 10 mm - 1/4" x 3/8" |
| PROPIEDADES / Properties | |
| VALOR / VALUE | |
| Densidad / Density: lb/ft ³ (kg/m ³) | 9 (144) |
| Adhesión / Adhesion: peel 90°, oz/in (N/cm) | 37.0 (405) |
| Resistencia a la tensión / Tensile strength: psi (kPa) | 40 (276) |
| Elongación de la espuma / Foam elongation | 100% |
| Dureza / Hardness: 00 | 28 |
| Abosrcion al agua/ Water absorption: % | 2.5 |
| Fuerza para comprimir / Compressive strength: 30% PSI (kPa) | 3.5 (24) |
| Defelxión al comprimir / Compressive deflection: PSI (kPa) | 2.0 (14) |
| Compresión al fijarse / Compression on setting: % | 8 |
| Temperatura de aplicación / Application temperature | 4 °C a 52 °C (40 °F a 125 °F) |
| Temperatura de trabajo / Working temperature | -26 °C a 71 °C (-15 °F a 160 °F) |

Sellador de silicon - Silicone sealant



| Code - Código | Dimensiones - Dimensions |
|---|---|
| SIG000000 | 300ml |
| PROPIEDADES / Properties | |
| VALOR / VALUE | |
| Base Química / Chemical base | New formulation of polyurethane |
| Apariencia / Aspect | Pasta / Paste |
| Densidad / Density | 1.3 gr/ml - 173.1 oz/Gal |
| Tiempo sin tensión / Tack-free time | 90 min |
| Proporción de curado / Curing ratio | 3 mm/día - 0.1 in / day |
| Temperatura de Aplicación / Application temperature | +5° C to +40°C - 41°F a 104°F |
| Temperatura de trabajo / Service temperature | -30°C to +80°C -22°F to 176°F |
| Dureza / Hardness | Shore A 30 |
| Resistencia de Tracción / Tensile strength | 0,72 N/mm ² 104.4 Lb/in ² |
| Elongación / Elongation | >500% |
| Capacidad de movimiento / Movement capacity | 50 % |
| VOC | 0.0000019 g/l |

Complementos - Installation Complements

Closure Isocop



| Code - Código | Tipo - Type | Uso - Application |
|--|---------------------|---------------------------------------|
| 5100009118 | 4 crestas 4 rows | Acero Galvanizado Galvanized Steel |
| Linear working length 3ft - Long. de trabajo 1 m | | |

Láminas lisas (Color Estandar) - Plain sheets (Standard colors)



| Color | Dimensiones - Dimensions | Material |
|-------------|---|---------------|
| 9010 / 9002 | 4" x 10" (50 pzas) calibre 24 y 26 4" x 10" (50 pcs) gauge 24 y 26 | Acero - Steel |

Láminas Lisas (Color Especial) - Plain sheets (Special colors)

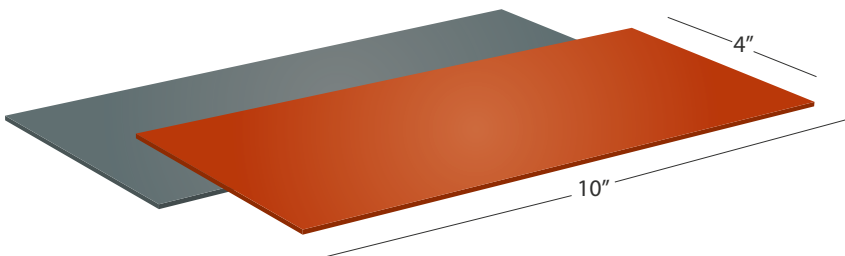

| Color | Dimensiones - Dimensions | Material |
|---------------------------------|--|---------------|
| *Color Especial - Special Color | 4" x 10" (50pzas) gauge 24 y 26 4" x 10" (50 pcs) gauge 24 y 26 | Acero - Steel |

*A reserva de disponibilidad de acero
*Subject to steel availability

Complementos - Installation Complements

Isolite 40/2.5

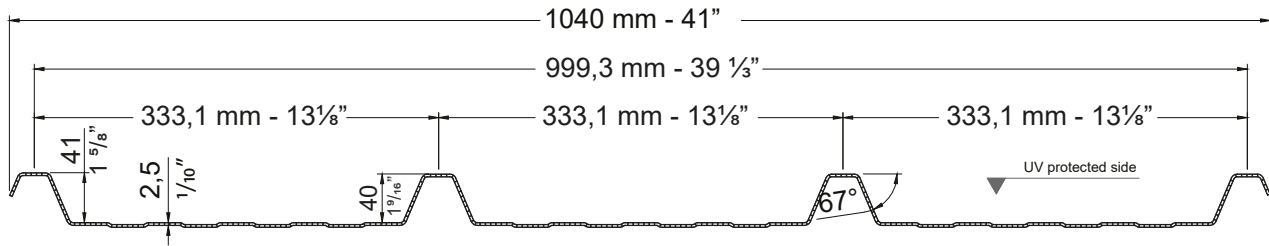
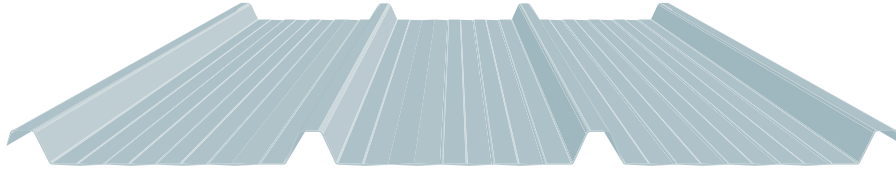

Isolite 40/8

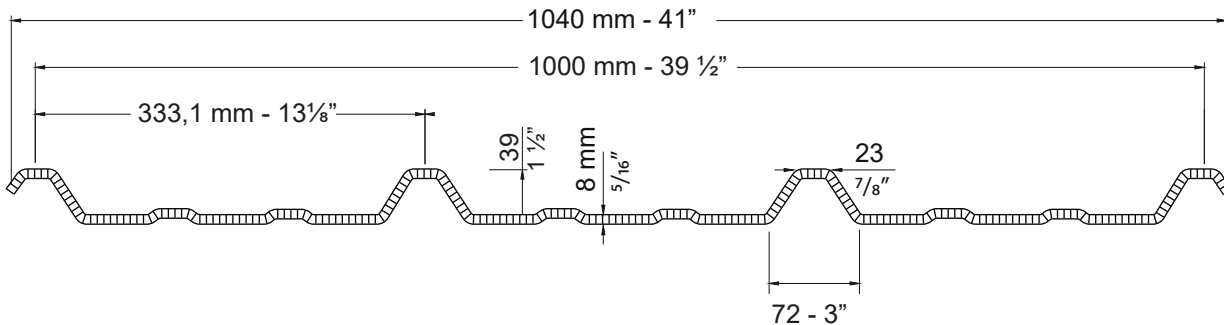
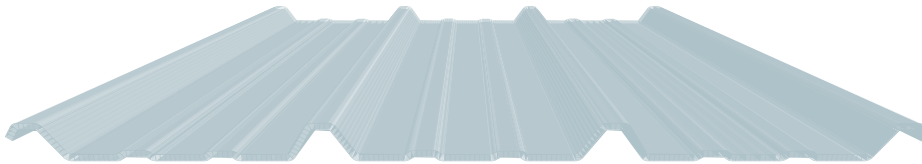

Complementos - Installation Complements

Isolite Wall 40/10

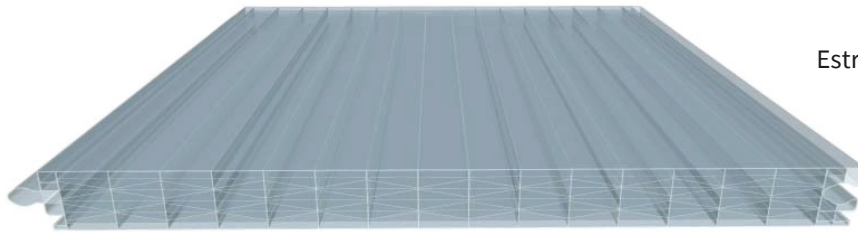

Estructura: 11 paredes por celda 40 mm
11 partitions per cell 1⁹/₁₆"

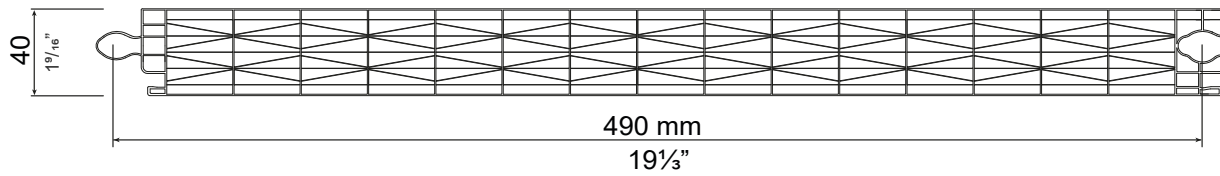

Isolite lisa 30

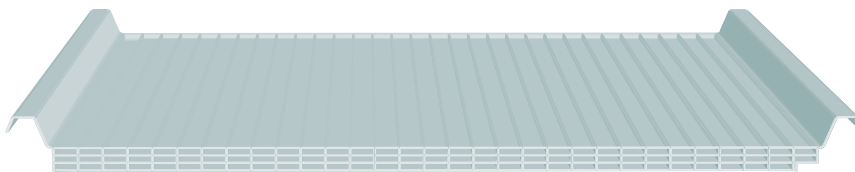

Estructura: 4 paredes por celda
4 partitions per cell

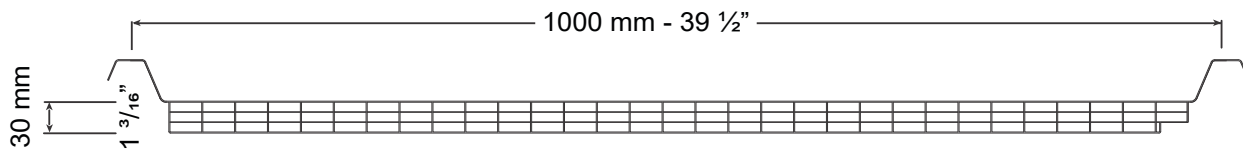

Trims - Molduras

Channel wrap trim - Canal "U"

ISO L 0

External Pre-painting - Pre-pintado Externo

| Panel thickness - Espesor del panel | Develop - Desarrollo |
|-------------------------------------|----------------------|
| 1" | 8 1/8" - 206mm |
| 1 1/4" | 8 3/8" - 213mm |
| 1 1/2" | 8 5/8" - 219mm |
| 1 5/8" | 8 3/4" - 222mm |
| 2" | 9 1/8" - 232mm |
| 2 1/2" | 9 5/8" - 245mm |
| 3" | 10 1/8" - 257mm |
| 4" | 11 1/8" - 283mm |
| 5" | 12 1/8" - 308mm |
| 6" | 13 1/8" - 333mm |
| 8" | 15 1/8" - 384mm |

| Code - Código | Material |
|---------------|---|
| ISO L 0 | Steel gauge 26 & 24 - Acero calibre 26 o 24 |

Linear working length 10 ft - Long. de trabajo 3.05 m lineales

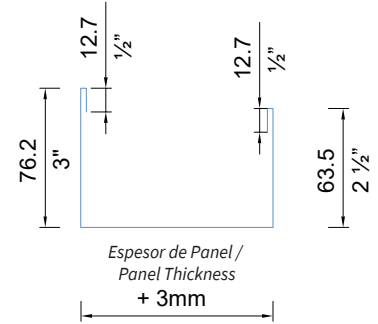
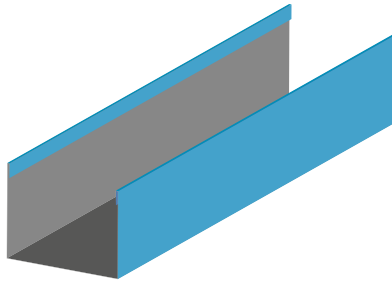

Drip edge profile - Perfil goterón para todos los tipos

ISO L 1a

External Pre-painting - Pre-pintado Externo

| Develop - Desarrollo | |
|----------------------|--|
| 16 3/8" 416 | |
| inch mm | |

| Code - Código | Material |
|---------------|---|
| ISO L 1a | Steel gauge 26 & 24 - Acero calibre 26 o 24 |

Linear working length 10 ft - Long. de trabajo 3.05 m lineales

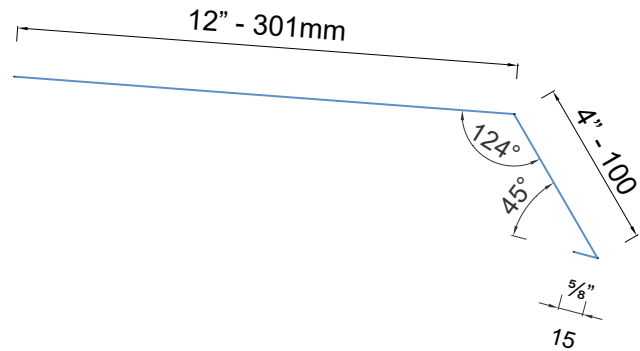
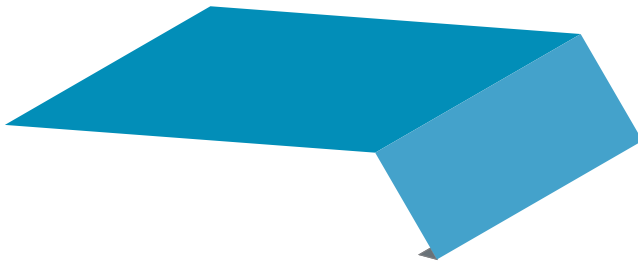

Drip edge profile - Perfil goterón para todos los tipos

ISO L 1b

External Pre-painting - Pre-pintado Externo

| Develop - Desarrollo | |
|----------------------|--|
| 10" 250 | |
| inch mm | |

| Code - Código | Material |
|---------------|---|
| ISO L 1b | Steel gauge 26 & 24 - Acero calibre 26 o 24 |

Linear working length 10 ft - Long. de trabajo 3.05 m lineales

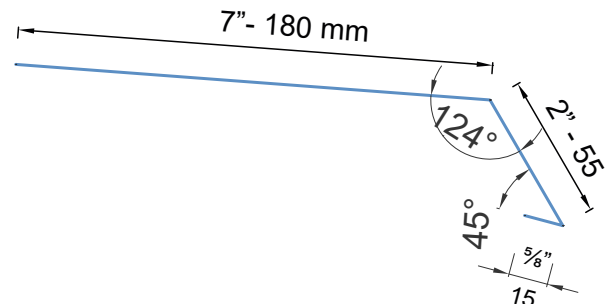
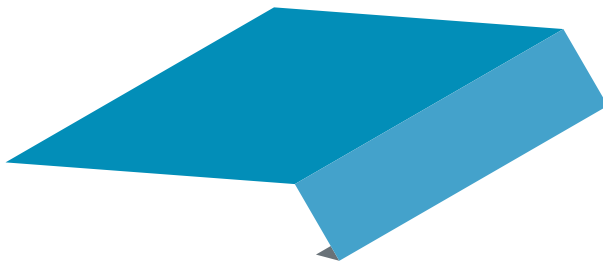

Trims - Molduras

Corner trim for wall and roof panel external joint - Moldura angular para lado exterior de juntas de muro y techo

ISO L 2a

External Pre-painting - Prepintado Externo

| Develop - Desarrollo | | Code - Código | Material |
|----------------------|-----|---------------|---|
| 16 3/8 | 416 | ISO L 2a | Steel gauge 26 & 24 - Acero calibre 26 o 24 |
| inch | mm | | |

Linear working length 10 ft - Long. de trabajo 3.05 m lineales

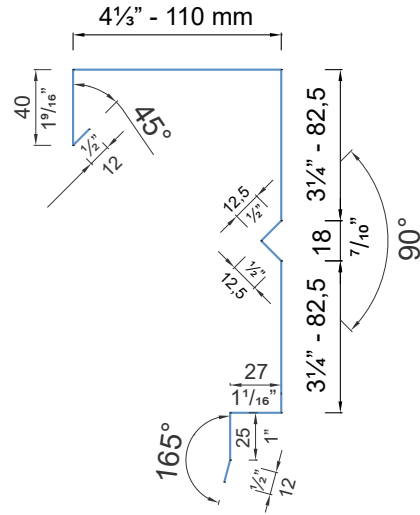

Protection trim for wall panel exterior joints - Moldura protectora para juntas exteriores de muro / techo

ISO L 2b

External Pre-painting - Prepintado Externo

| Develop - Desarrollo | | Code - Código | Material |
|----------------------|-----|---------------|---|
| 16 1/2" | 416 | ISO L 2b | Steel gauge 26 & 24 - Acero calibre 26 o 24 |
| inch | mm | | |

Linear working length 10 ft - Long. de trabajo 3.05 m lineales

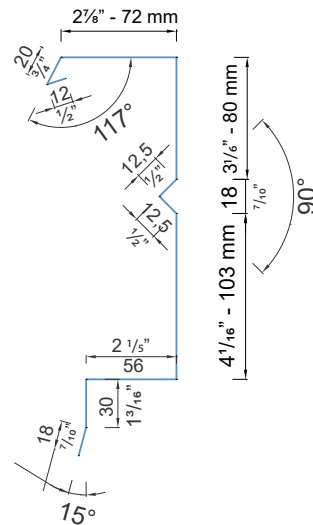

Trims - Molduras

Base Trim - Remate

ISO L 3

External Pre-painting - Prepintado Externo

| Develop - Desarrollo | | Code - Código | Material |
|----------------------|-----|---------------|---|
| 16 3/8 | 416 | ISO L 3 | Steel gauge 26 & 24 - Acero calibre 26 o 24 |
| inch | mm | | |

Linear working length 10 ft - Long. de trabajo 3.05 m lineales

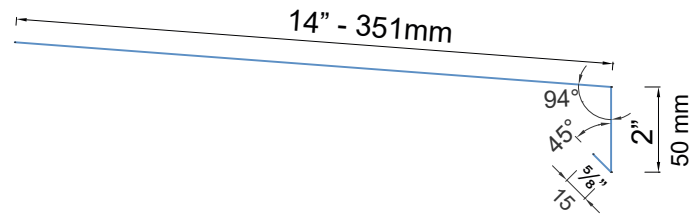

Protective coping for parapets - Moldura protectora para parapetos

ISO L 4

External Pre-painting - Prepintado Externo

| Develop - Desarrollo | | Code - Código | Material |
|----------------------|-----|---------------|---|
| 12" | 312 | ISO L 4 | Steel gauge 26 & 24 - Acero calibre 26 o 24 |
| inch | mm | | |

Linear working length 10 ft - Long. de trabajo 3.05 m lineales

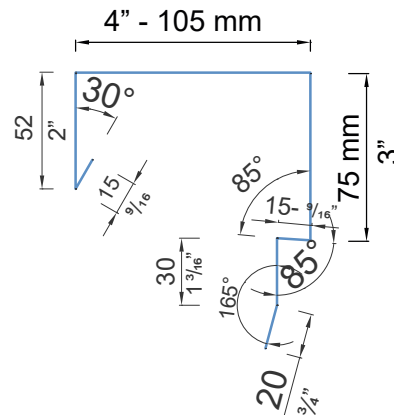

Trims - Molduras

Parapet coping - Moldura protectora para parapetos

ISO L 5

External Pre-painting - Prepintado Externo

| Development - Desarrollo | | Code - Código | Material |
|--------------------------|-----|---------------|---|
| 25½" | 624 | ISO L 5 | Steel gauge 26 & 24 - Acero calibre 26 o 24 |
| inch | mm | | |

Linear working length 10 ft - Long. de trabajo 3.05 m lineales

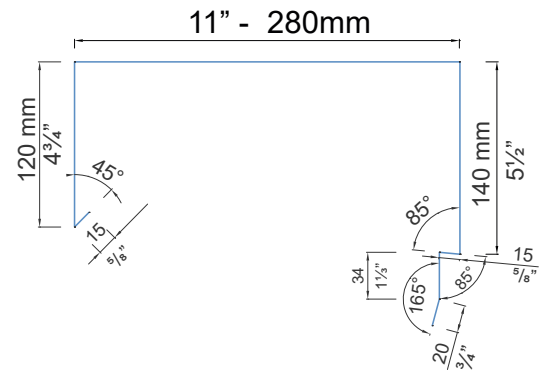

Angle trim for wall panel internal joint - Moldura angular para lado interno de juntas de panel de muro

ISO L 6

External Pre-painting - Prepintado Externo

| Develop - Desarrollo | | Code - Código | Material |
|----------------------|-----|---------------|---|
| 10" | 250 | ISO L 6 | Steel gauge 26 & 24 - Acero calibre 26 o 24 |
| inch | mm | | |

Linear working length 10 ft - Long. de trabajo 3.05 m lineales

Check with customer for bending angle - Consultar con cliente ángulo de doblez

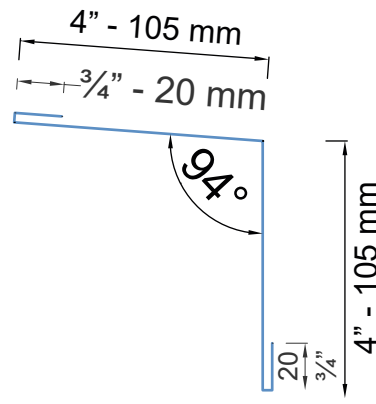
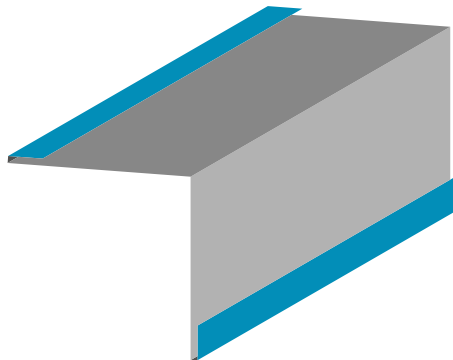

Trims - Molduras

Outside corner trim - Esquinero externo

ISO L 7

External Pre-painting - Prepintado Externo

| Develop - Desarrollo | | Code - Código | Material |
|----------------------|-----|---------------|---|
| 5" | 125 | ISO L 7 | Steel gauge 26 & 24 - Acero calibre 26 o 24 |
| inch | mm | | |

Linear working length 10 ft - Long. de trabajo 3.05 m lineales

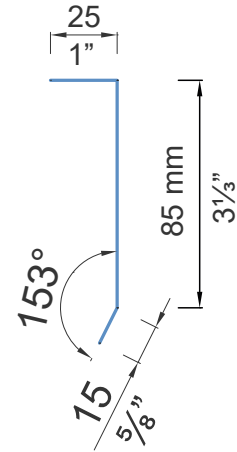
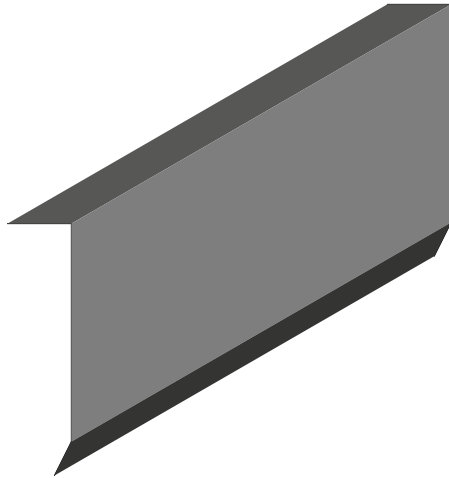

Wall Panel Base Trim - Remate para paneles de muro

ISO L 8

External Pre-painting - Prepintado Externo

| Develop - Desarrollo | | Code - Código | Material |
|----------------------|-----|---------------|---|
| 6" | 156 | ISO L 8 | Steel gauge 26 & 24 - Acero calibre 26 o 24 |
| inch | mm | | |

Linear working length 10 ft - Long. de trabajo 3.05 m lineales

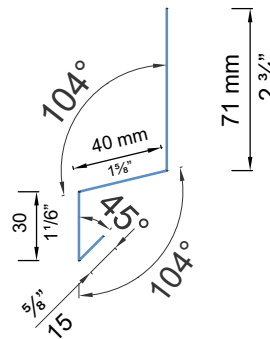
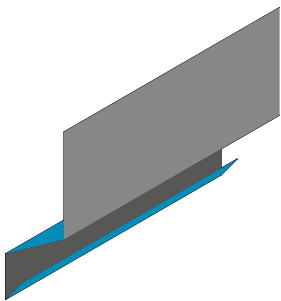

Trims - Molduras

Simple ridge trim - Cumbre simple para todos los perfiles

ISO L 10D

External Pre-painting - Prepintado Externo

| Develop - Desarrollo | | Code - Código | Material |
|----------------------|-----|---------------|---|
| 16% | 416 | ISO L 10D | Steel gauge 26 & 24 - Acero calibre 26 o 24 |
| inch | mm | | |

Linear working length 10 ft - Long. de trabajo 3.05 m lineales

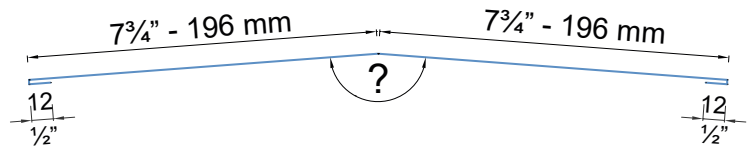
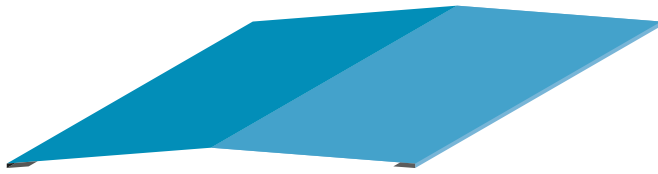

Simple sub-ridge trim - Subcumbre simple para todos los tipos

ISO L 11

External Pre-painting - Prepintado Externo

| Develop - Desarrollo | | Code - Código | Material |
|----------------------|-----|---------------|---|
| 25" | 624 | ISO L 11 | Steel gauge 26 & 24 - Acero calibre 26 o 24 |
| inch | mm | | |

Linear working length 10 ft - Long. de trabajo 3.05 m lineales

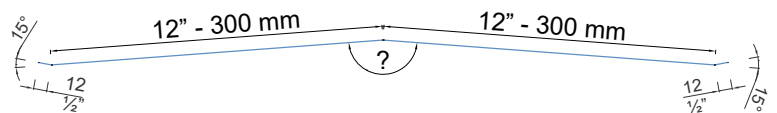
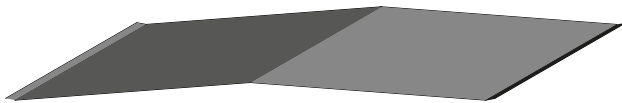

Trims - Molduras

Cover Trim - Cubierta para todos los perfiles

ISO L 12a

External Pre-painting - Pre-pintado Externo

| Develop - Desarrollo | | Code - Código | Material |
|----------------------|-----|---------------|---|
| 25" | 624 | ISO L 12a | Steel gauge 26 & 24 - Acero calibre 26 o 24 |
| inch | mm | | |

- Linear working length 10 ft - Long. de trabajo 3.05 m lineales
- Specify overlap length - Especificar longitud de traslape
- No cut solution - Solución sin corte
- Important to combine trim with closure - Importante combinar moldura con closure
- Linear working length 120" - Long. de trabajo 3.05 m lineales

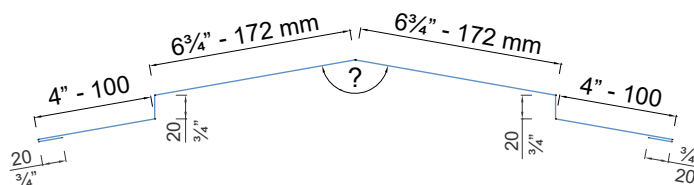
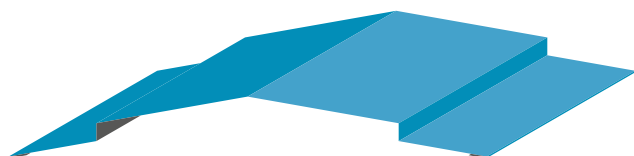

Cover Trim - Cubierta para todos los perfiles

ISO L12b

External Pre-painting - Pre-pintado Externo

| Develop - Desarrollo | | Code - Código | Material |
|----------------------|-----|---------------|---|
| 16 3/8" | 416 | ISO L 12b | Steel gauge 26 & 24 - Acero calibre 26 o 24 |
| inch | mm | | |

- Linear working length 10 ft - Long. de trabajo 3.05 m lineales
- Specify overlap length - Especificar longitud de traslape
- No cut solution - Solución sin corte
- Important to combine trim with closure - Importante combinar moldura con closure
- Linear working length 120" - Long. de trabajo 3.05 m lineales

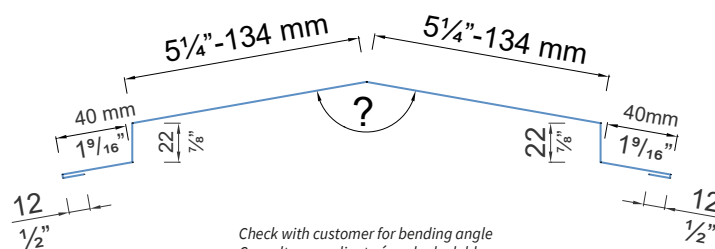
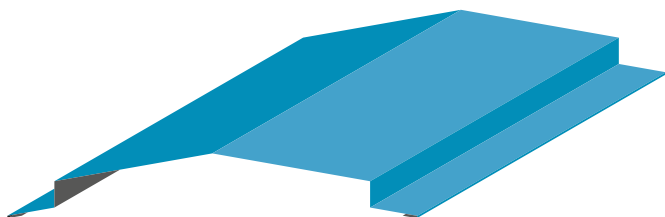

Trims - Molduras

Cantilever roof edge trim - Moldura de borde para techos con cantiliver

ISO L 13

External Pre-painting - Prepintado Externo

| Development - Desarrollo | | Code - Código | Material |
|--------------------------|-----|---------------|---|
| 12" | 312 | ISO L 13 | Steel gauge 26 & 24 - Acero calibre 26 o 24 |
| inch | mm | | |

Linear working length 10 ft - Long. de trabajo 3.05 m lineales

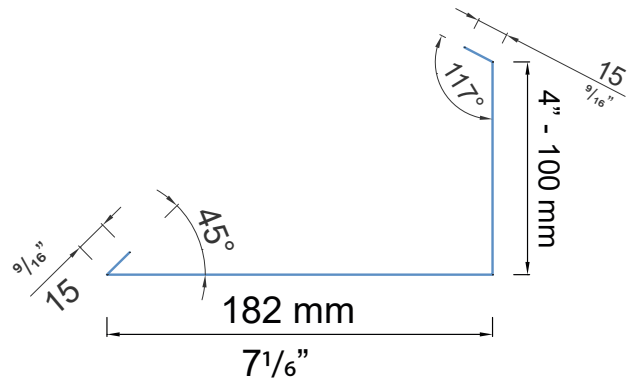

Corner trim for wall and roof panel internal joint - Moldura angular para lado interno de juntas de muro y techo

ISO L 14

External Pre-painting - Prepintado Externo

| Develop - Desarrollo | | Code - Código | Material |
|----------------------|-----|---------------|---|
| 6" | 156 | ISO L 14 | Steel gauge 26 & 24 - Acero calibre 26 o 24 |
| inch | mm | | |

Linear working length 10 ft - Long. de trabajo 3.05 m lineales

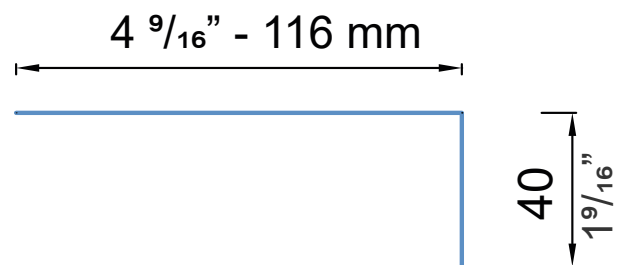

Trims - Molduras

Exterior trim molding for wall and ceiling joints - Moldura protectora para juntas exteriores de muro y techo

ISO L 15

External Pre-painting - Prepintado Externo

| Development - Desarrollo | | Code - Código | Material |
|--------------------------|-----|---------------|---|
| 25" | 624 | ISO L 15 | Steel gauge 26 & 24 - Acero calibre 26 o 24 |
| inch | mm | | |

Linear working length 10 ft - Long. de trabajo 3.05 m lineales

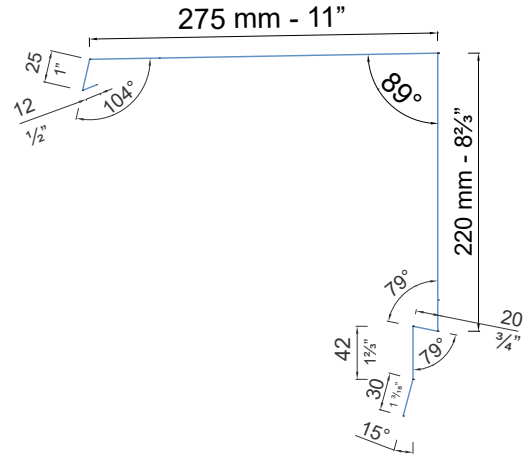

Exterior trim molding for wall and ceiling joints - Moldura protectora para juntas exteriores de muro y techo

ISO L 16

External Pre-painting - Prepintado Externo

| Development - Desarrollo | | Code - Código | Material |
|--------------------------|-----|---------------|---|
| 25" | 624 | ISO L 16 | Steel gauge 26 & 24 - Acero calibre 26 o 24 |
| inch | mm | | |

Linear working length 10 ft - Long. de trabajo 3.05 m lineales

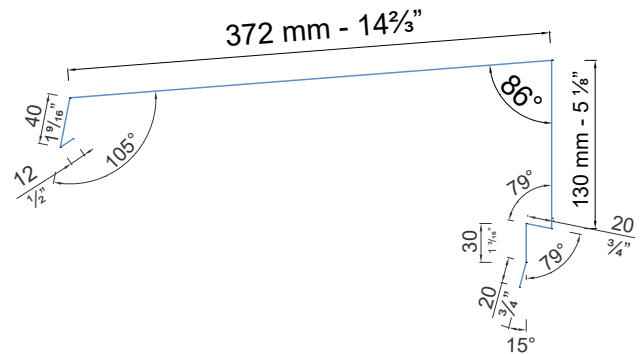
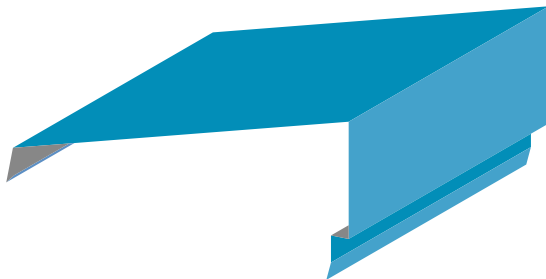

Trims - Molduras

Corner trim for wall and roof panel internal joint - Moldura angular para lado interno de juntas de muro y techo

ISO L 18

External Pre-painting - Pre-pintado Externo

| Develop - Desarrollo | | Code - Código | Material |
|----------------------|-----|---------------|---|
| 12 ¼" | 312 | ISO L 18 | Steel gauge 26 & 24 - Acero calibre 26 o 24 |
| inch | mm | | |

Linear working length 10 ft - Long. de trabajo 3.05 m lineales

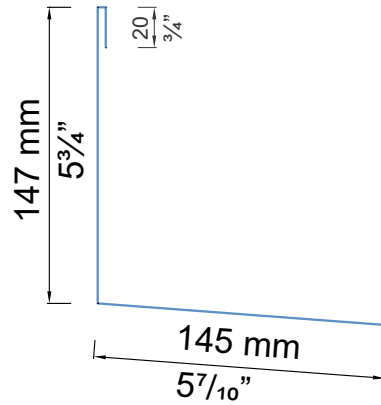
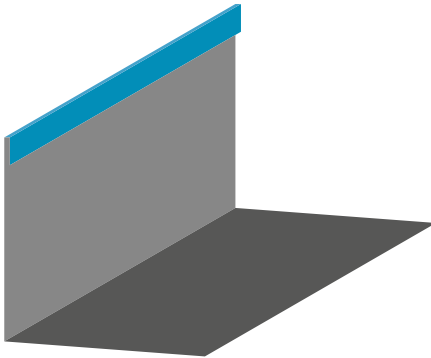

Angle trim for lower joints / Moldura angular para todas las juntas inferiores

ISO L 19

External Pre-painting - Pre-pintado Externo

| Develop - Desarrollo | | Code - Código | Material |
|----------------------|-----|---------------|---|
| 16 ¾" | 416 | ISO L 19 | Steel gauge 26 & 24 - Acero calibre 26 o 24 |
| inch | mm | | |

Linear working length 10 ft - Long. de trabajo 3.05 m lineales
 - Specify overlap length - Especificar longitud de traslape
 - Linear working length 120" - Long. de trabajo 3.05 m lineales

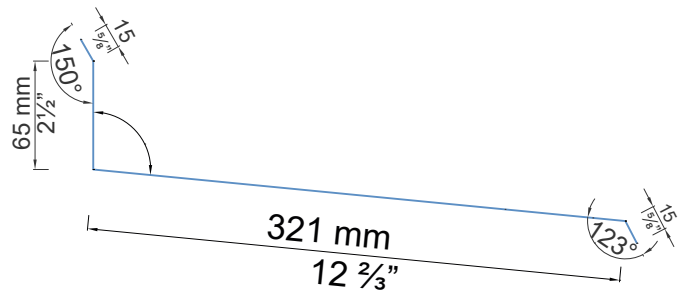
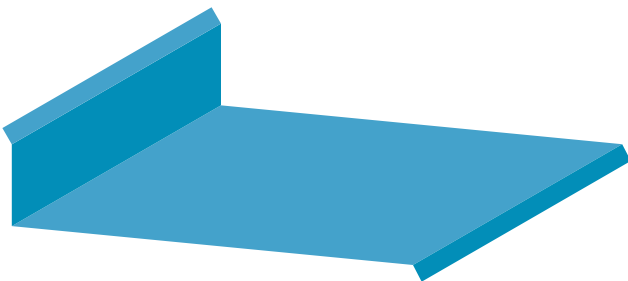

Trims - Molduras

Bottom trim for lower joints - Moldura inferior para todas las juntas inferiores

ISO L 19 D

External Pre-painting - Pre-pintado Externo

| Develop - Desarrollo | | Code - Código | Material |
|----------------------|-----|---------------|---|
| 10" | 250 | ISO L 19D | Steel gauge 26 & 24 - Acero calibre 26 o 24 |
| inch | mm | | |

Linear working length 10 ft - Long. de trabajo 3.05 m lineales
 - Specify overlap length - Especificar longitud de traslape
 - Linear working length 120" - Long. de trabajo 3.05 m lineales

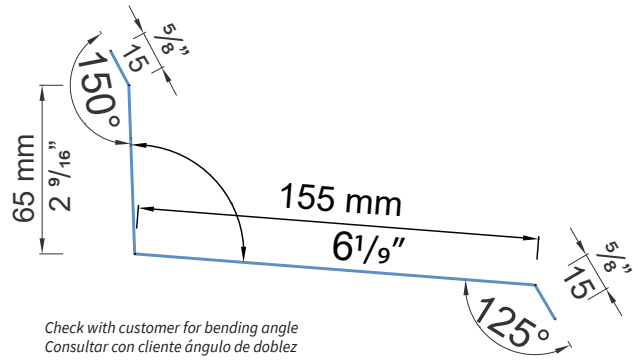
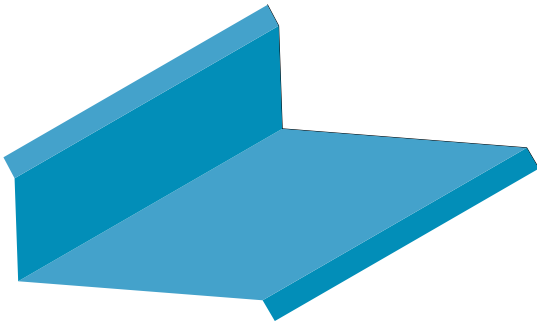

Horizontal drip edge trim for horizontal wall - Goterón horizontal para junta horizontal de muro

ISO L 20

External Pre-painting - Pre-pintado Externo

| Develop - Desarrollo | | Code - Código | Material |
|----------------------|-----|---------------|---|
| 7" | 178 | ISO L 20 | Steel gauge 26 & 24 - Acero calibre 26 o 24 |
| inch | mm | | |

Linear working length 10 ft - Long. de trabajo 3.05 m lineales

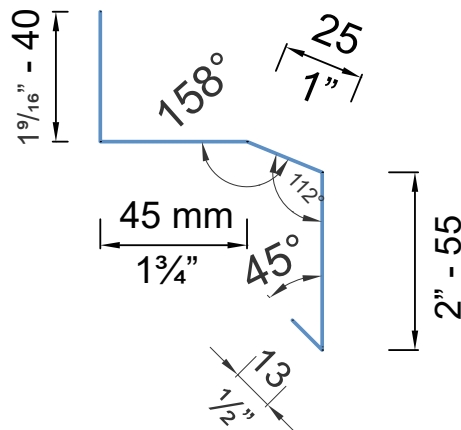

Trims - Molduras

Drip edge trim for wall panel joint - Goterón para junta de panel de techo

ISO L 21

External Pre-painting - Prepintado Externo

| Develop - Desarrollo | | Code - Código | Material |
|----------------------|-----|---------------|---|
| 12" | 312 | ISO L 21 | Steel gauge 26 & 24 - Acero calibre 26 o 24 |
| inch | mm | | |

Linear working length 10 ft - Long. de trabajo 3.05 m lineales

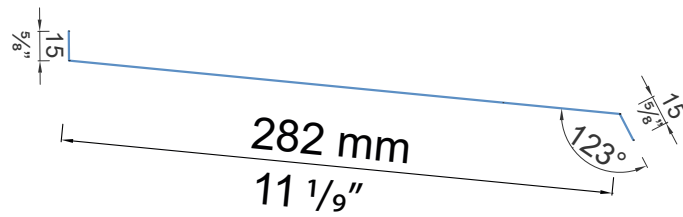
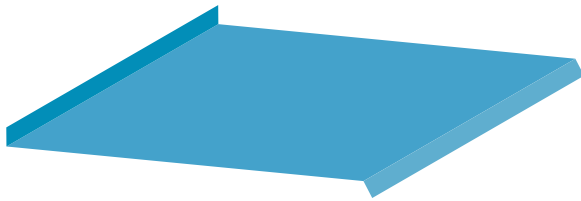

Corner trim for wall and roof panel internal joint - Moldura angular para lado interno de juntas de muro y techo

ISO L 22

External Pre-painting - Prepintado Externo

| Develop - Desarrollo | | Code - Código | Material |
|----------------------|-----|---------------|---|
| 6 1/4" | 156 | ISO L 22 | Steel gauge 26 & 24 - Acero calibre 26 o 24 |
| inch | mm | | |

Linear working length 10 ft - Long. de trabajo 3.05 m lineales

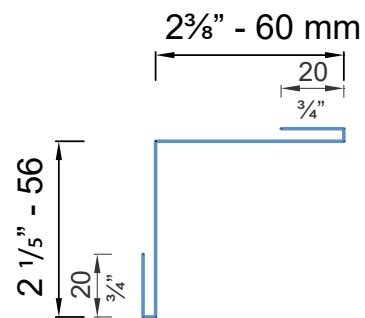
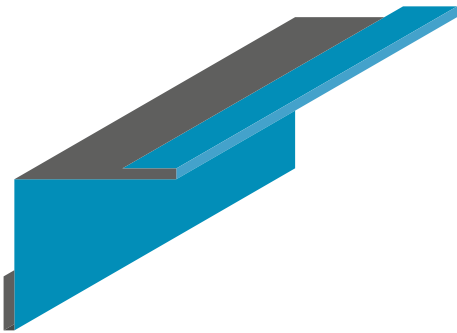

Trims - Molduras

Cover trim for expansion joints - Moldura de tapa para juntas móviles

ISO L 23

External Pre-painting - Pre pintado Externo

| Develop - Desarrollo | | Code - Código | Material |
|----------------------|-----|---------------|---|
| 6 1/8" | 156 | ISO L 23 | Steel gauge 26 & 24 - Acero calibre 26 o 24 |
| inch | mm | | |

Linear working length 10 ft - Long. de trabajo 3.05 m lineales

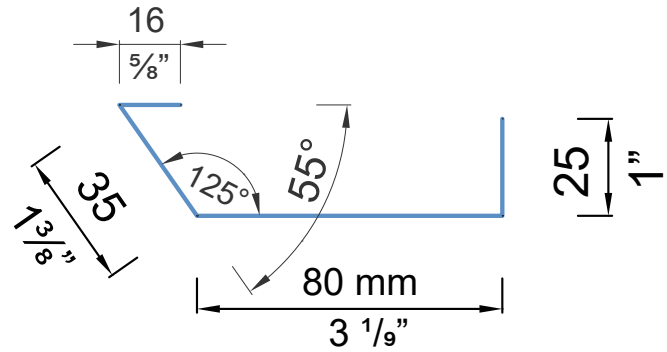
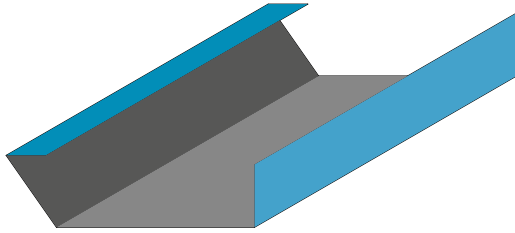

Cover trim for expansion joints - Moldura de tapa para juntas móviles

ISO L 24

External Pre-painting - Pre pintado Externo

| Develop - Desarrollo | | Code - Código | Material |
|----------------------|-----|---------------|---|
| 8 3/8" | 221 | ISO L 24 | Steel gauge 26 & 24 - Acero calibre 26 o 24 |
| inch | mm | | |

Linear working length 10 ft - Long. de trabajo 3.05 m lineales

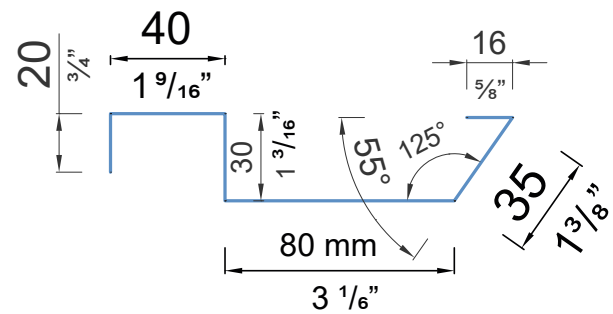

Trims - Molduras

Z-shaped metal stud - Perfil Z

ISO L 25

External Pre-painting - Prepintado Externo

| Develop - Desarrollo | | Code - Código | Material |
|----------------------|----|---------------|---|
| 3" | 78 | ISO L 25 | Steel gauge 26 & 24 - Acero calibre 26 o 24 |
| inch | mm | | |

Linear working length 10 ft - Long. de trabajo 3.05 m lineales

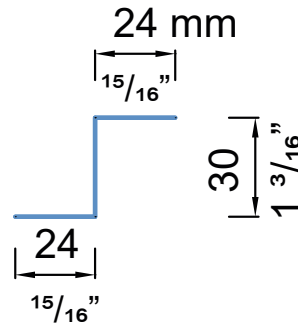
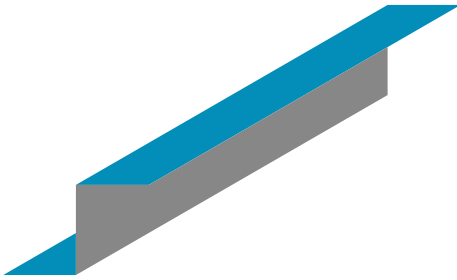

External cover trim for vertical joints - Moldura tapa externa para juntas verticales

ISO L 26

External Pre-painting - Prepintado Externo

| Develop - Desarrollo | | Code - Código | Material |
|----------------------|-----|---------------|---|
| 12 1/4" | 312 | ISO L 26 | Steel gauge 26 & 24 - Acero calibre 26 o 24 |
| inch | mm | | |

Linear working length 10 ft - Long. de trabajo 3.05 m lineales

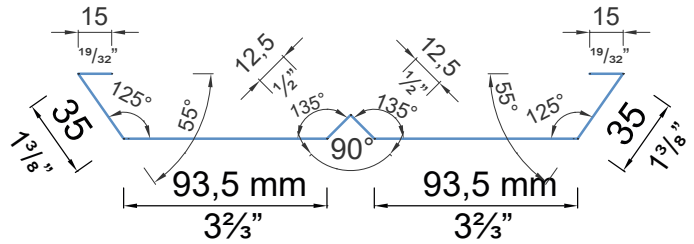
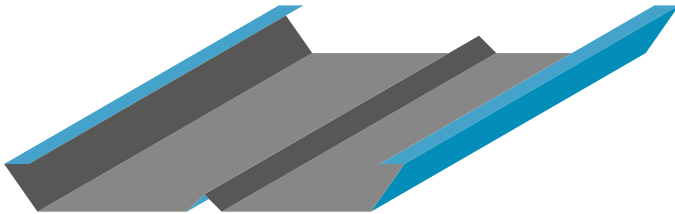

External cover trim for vertical joints - Moldura tapa externa para juntas verticales

ISO L 26b

External Pre-painting - Prepintado Externo

| Develop - Desarrollo | | Code - Código | Material |
|----------------------|-----|---------------|---|
| 16 3/8" | 416 | ISO L 26b | Steel gauge 26 & 24 - Acero calibre 26 o 24 |
| inch | mm | | |

Linear working length 10 ft - Long. de trabajo 3.05 m lineales

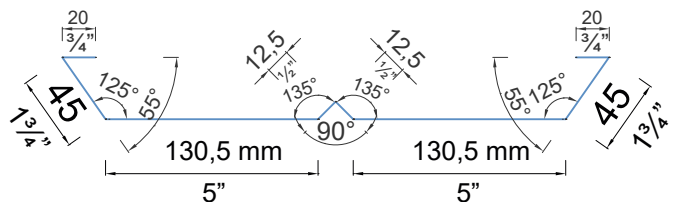
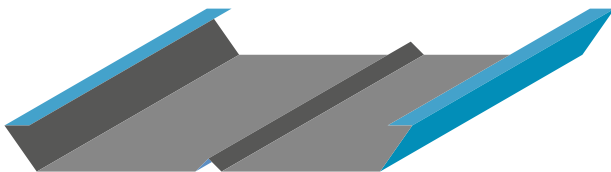

Trims - Molduras

External cover trim for vertical joints - Moldura tapa externa para juntas verticales

ISO L 27

External Pre-painting - Prepintado Externo

| Develop - Desarrollo | | Code - Código | Material |
|----------------------|-----|---------------|---|
| 5" | 125 | ISO L 27 | Steel gauge 26 & 24 - Acero calibre 26 o 24 |
| inch | mm | | |

Linear working length 10 ft - Long. de trabajo 3.05 m lineales

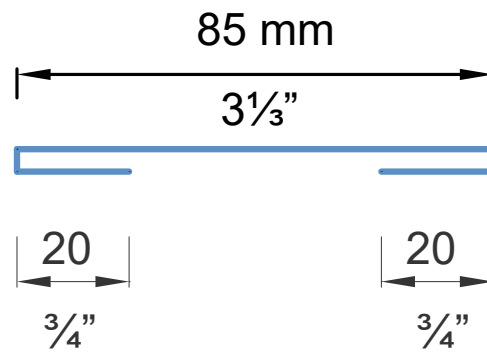
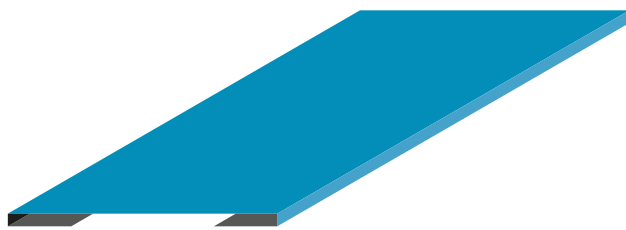

External cover trim for lower wall joint - Moldura tapa externa para junta inferior muro

ISO L 28

External Pre-painting - Prepintado Externo

| Develop - Desarrollo | | Code - Código | Material |
|----------------------|-----|---------------|---|
| 16 1/8" | 416 | ISO L 28 | Steel gauge 26 & 24 - Acero calibre 26 o 24 |
| inch | mm | | |

Linear working length 10 ft - Long. de trabajo 3.05 m lineales

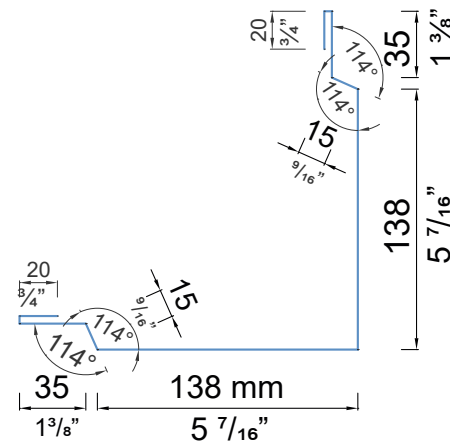
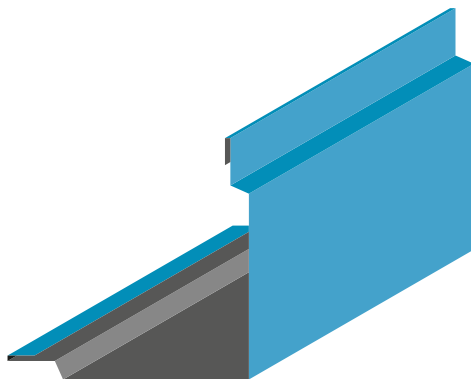

Trims - Molduras

External cover trim for lower wall joint - Moldura tapa externa para junta inferior muro

ISO L 29

External Pre-painting - Prepintado Externo

| Develop - Desarrollo | | Code - Código | Material |
|----------------------|-----|---------------|---|
| 24 1/2" | 624 | ISO L 29 | Steel gauge 26 & 24 - Acero calibre 26 o 24 |
| inch | mm | | |

Linear working length 10 ft - Long. de trabajo 3.05 m lineales

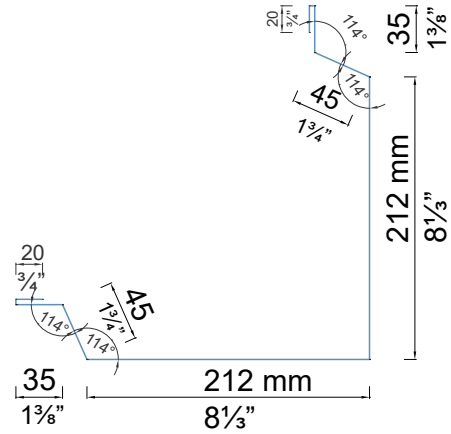
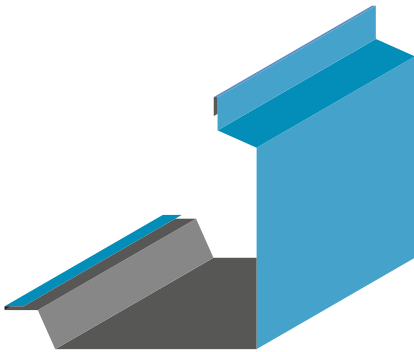

External cover trim for bottom wall joint (Inverted angle) - Moldura tapa externa para junta inferior muro (Angulo invertido)

ISO L 30

External Pre-painting - Prepintado Externo

| Develop - Desarrollo | | Code - Código | Material |
|----------------------|-----|---------------|---|
| 24 1/2" | 624 | ISO L 30 | Steel gauge 26 & 24 - Acero calibre 26 o 24 |
| inch | mm | | |

Linear working length 10 ft - Long. de trabajo 3.05 m lineales

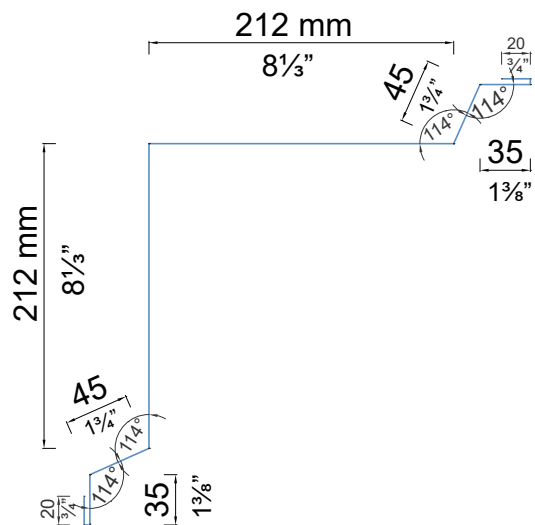
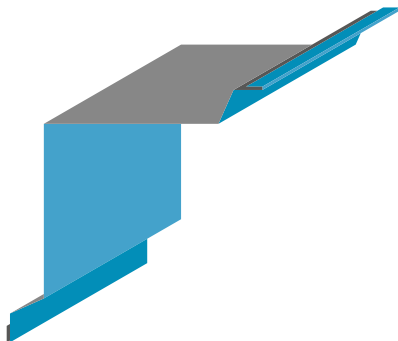

Trims - Molduras

External cover trim for bottom wall joint (Inverted angle) - Moldura tapa externa para junta inferior muro (Angulo invertido)

ISO L 31

External Pre-painting - Prepintado Externo

| Develop - Desarrollo | | Code - Código | Material |
|----------------------|-----|---------------|---|
| 16 1/2" | 416 | ISO L 31 | Steel gauge 26 & 24 - Acero calibre 26 o 24 |
| inch | mm | | |

Linear working length 10 ft - Long. de trabajo 3.05 m lineales

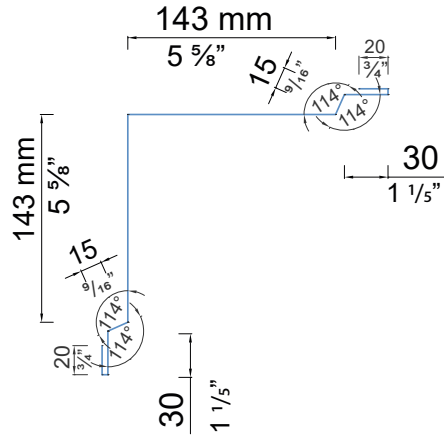
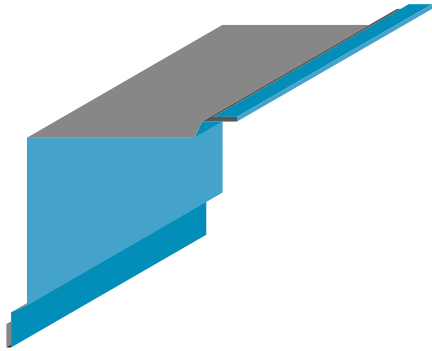

Internal trim cover for bottom wall joint - Moldura tapa interna para junta inferior muro

ISO L 32

External Pre-painting - Prepintado Externo

| Develop - Desarrollo | | Code - Código | Material |
|----------------------|-----|---------------|---|
| 10" | 250 | ISO L 32 | Steel gauge 26 & 24 - Acero calibre 26 o 24 |
| inch | mm | | |

Linear working length 10 ft - Long. de trabajo 3.05 m lineales

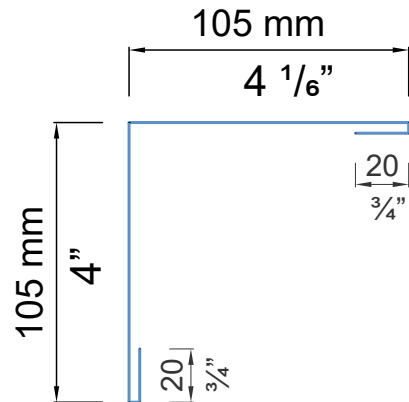
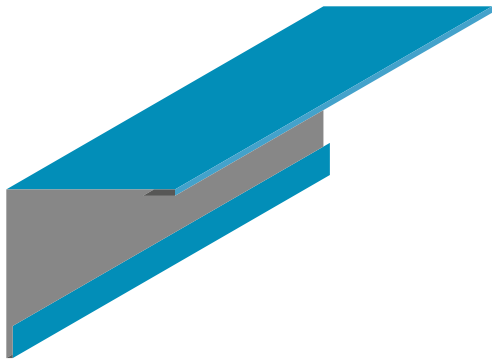

Trims - Molduras

Drip Edge - Goterón

ISO L 33

External Pre-painting - Prepintado Externo

| Develop - Desarrollo | | Code - Código | Material |
|----------------------|-----|---------------|---|
| 10" | 250 | ISO L 33 | Steel gauge 26 & 24 - Acero calibre 26 o 24 |
| inch | mm | | |

Linear working length 10 ft - Long. de trabajo 3.05 m lineales

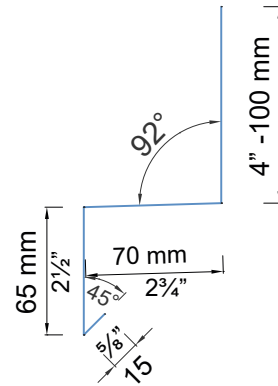

Internal trim cover for bottom wall joint - Moldura tapa interna para junta inferior muro

ISO L 34

External Pre-painting - Prepintado Externo

| Develop - Desarrollo | | Code - Código | Material |
|----------------------|-----|---------------|---|
| 12 1/4" | 312 | ISO L 34 | Steel gauge 26 & 24 - Acero calibre 26 o 24 |
| inch | mm | | |

Linear working length 10 ft - Long. de trabajo 3.05 m lineales

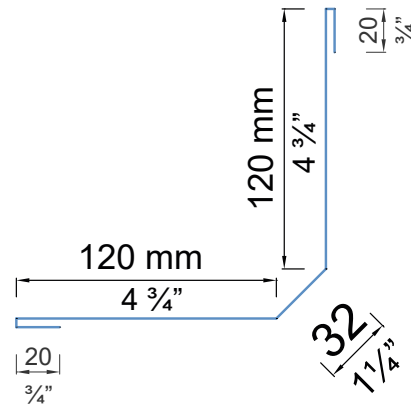
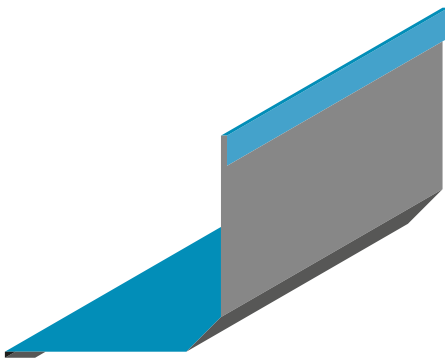

Trims - Molduras

Internal trim cover for bottom wall joint - Moldura tapa interna para junta inferior muro

ISO L 35

External Pre-painting - Prepintado Externo

| Develop - Desarrollo | | Code - Código | Material |
|----------------------|-----|---------------|---|
| 16 1/2" | 417 | ISO L 35 | Steel gauge 26 & 24 - Acero calibre 26 o 24 |
| inch | mm | | |

Linear working length 10 ft - Long. de trabajo 3.05 m lineales

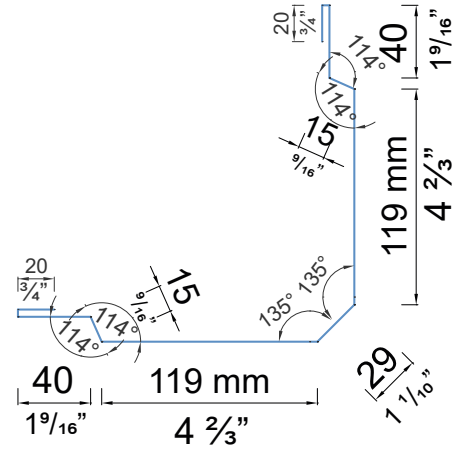
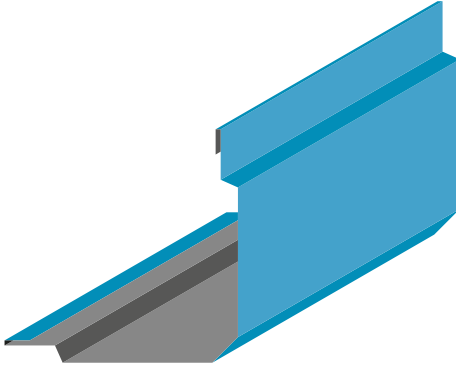

Internal trim cover for bottom wall joint - Moldura tapa interna para junta inferior muro

ISO L 36

External Pre-painting - Prepintado Externo

| Develop - Desarrollo | | Code - Código | Material |
|----------------------|-----|---------------|---|
| 24 3/4" | 625 | ISO L 36 | Steel gauge 26 & 24 - Acero calibre 26 o 24 |
| inch | mm | | |

Linear working length 10 ft - Long. de trabajo 3.05 m lineales

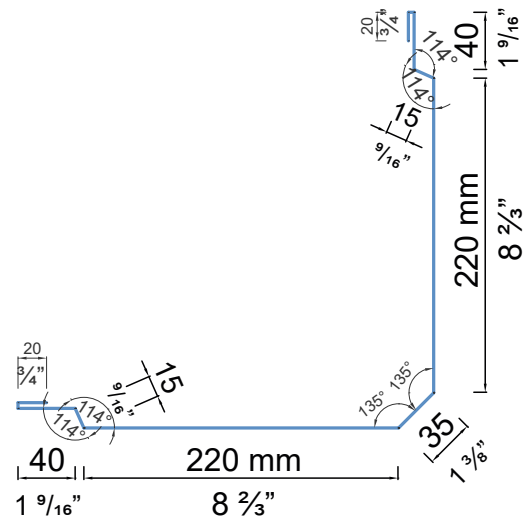
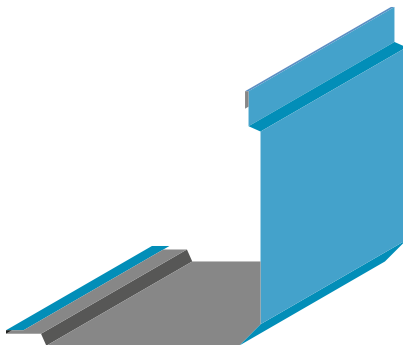

Trims - Molduras

Gutter for all profiles Panel Thickness $\leq 2"$ - Canalón para todos los perfiles (espesor de panel $\leq 50\text{mm}$)

ISO L 37

External Pre-painting - Pre-pintado Externo

| Develop - Desarrollo | | Code - Código | Material |
|----------------------|-----|---------------|---|
| 16 1/2" | 415 | ISO L 37 | Steel gauge 26 & 24 - Acero calibre 26 o 24 |
| inch | mm | | |

Linear working length 10 ft - Long. de trabajo 3.05 m lineales

- Linear working length 120" - Long. de trabajo 3.05 m lineales

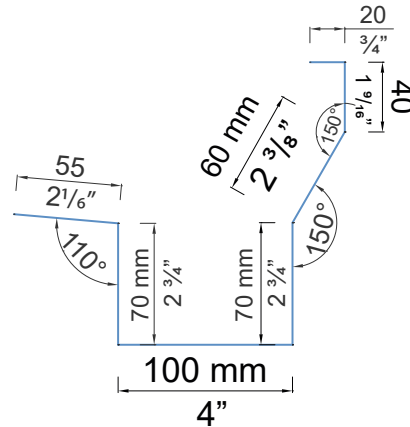
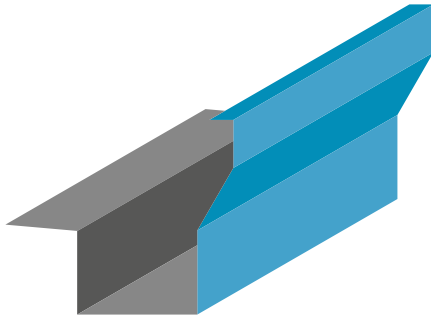

Canalón para todos los perfiles (espesor de panel $\leq 50\text{mm}$) - Gutter for all profiles (panel thickness $\leq 2"$)

ISO L 38

External Pre-painting - Pre-pintado Externo

| Develop - Desarrollo | | Code - Código | Material |
|----------------------|-----|---------------|---|
| 24 1/2" | 624 | ISO L 38 | Steel gauge 26 & 24 - Acero calibre 26 o 24 |
| inch | mm | | |

Linear working length 10 ft - Long. de trabajo 3.05 m lineales

- Linear working length 120" - Long. de trabajo 3.05 m lineales

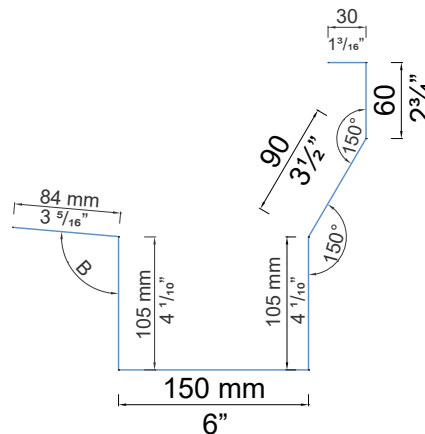

Trims - Molduras

Closed gutter for Isocop panel - Canalón cerrado para isocop

ISO L 39

External Pre-painting - Prepintado Externo

| Develop - Desarrollo | | Code - Código | Material |
|----------------------|-----|---------------|---|
| 24 ½" | 624 | ISO L 39 | Steel gauge 26 & 24 - Acero calibre 26 o 24 |
| inch | mm | | |

Linear working length 10 ft - Long. de trabajo 3.05 m lineales

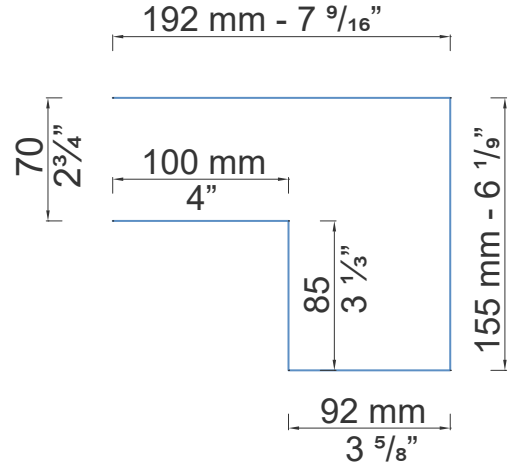

Closed gutter for Isodomus - Canalón cerrado para isodomus

ISO L 39 D

External Pre-painting - Prepintado Externo

| Develop - Desarrollo | | Code - Código | Material |
|----------------------|-----|---------------|---|
| 24 ½" | 624 | ISO L 39 D | Steel gauge 26 & 24 - Acero calibre 26 o 24 |
| inch | mm | | |

Linear working length 10 ft - Long. de trabajo 3.05 m lineales

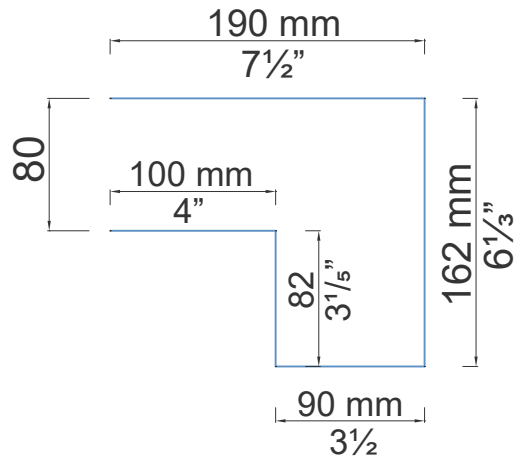

Trims - Molduras

Joint Cap for 1⁹/₁₆" - Tapa junta para 40 mm

ISO L 45

External Pre-painting - Pre-pintado Externo

| Develop - Desarrollo | | Code - Código | Material |
|--|-----------|---------------|---|
| 5 ⁷ / ₁₆ " inch | 138 mm | ISO L 45 | Steel gauge 26 & 24 - Acero calibre 26 o 24 |

Linear working length 10 ft - Long. de trabajo 3.05 m lineales

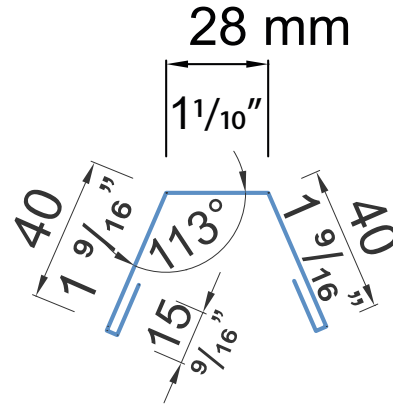
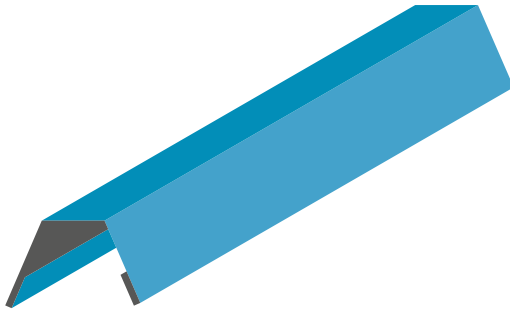

Clip-on trim for corrugated roof panel - Tapa junta tipo clip para paneles de techo corrugado

ISO L 46

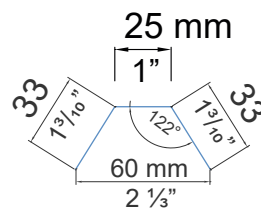
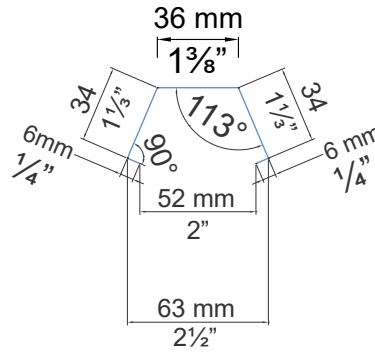
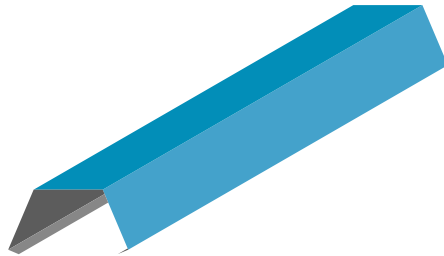

External Pre-painting - Pre-pintado Externo

| Descripción - Description | Material |
|------------------------------------|---|
| Tapajunta tipo Clip / Clip-on trim | Steel gauge 26 & 24 - Acero calibre 26 o 24 |
| Tapajunta tipo Clip / Clip-on trim | Steel gauge 26 & 24 - Acero calibre 26 o 24 |

Develop - Desarrollo

| | |
|--|----------|
| 4 ⁹ / ₁₆ + 3 ⁵ / ₈ " | 116 + 91 |
| inch | mm |

Tornillo autotaladrante cabeza plana - Self-drilling screw flat head

Ø X LARGO Ø X LENGHT

| | |
|--------------|---------------|
| 6,3 x 110 mm | 1/4" x 4 1/3" |
| 6,3 x 120 mm | 1/4" x 4 3/4" |
| 6,3 x 130 mm | 1/4" x 5 1/8" |
| 6,3 x 140 mm | 1/4" x 5 1/2" |
| 6,3 x 160 mm | 1/4" x 6 1/4" |
| 6,3 x 180 mm | 1/4" x 7" |
| 6,3 x 200 mm | 1/4" x 8" |

- Linear working length 120" - Long. de trabajo 3.05 m lineales



Tapa Junta / Trim



Clip

Trims - Molduras

Corner molding for all bottom joints - Moldura adaptable angular para todas las juntas inferiores

ISO L 47

External Pre-painting - Prepintado Externo

| Develop - Desarrollo | | Code - Código | Material |
|----------------------|-----|---------------|---|
| 12 ¼" | 312 | ISO L 47 | Steel gauge 26 & 24 - Acero calibre 26 o 24 |
| inch | mm | | |

Linear working length 10 ft - Long. de trabajo 3.05 m lineales

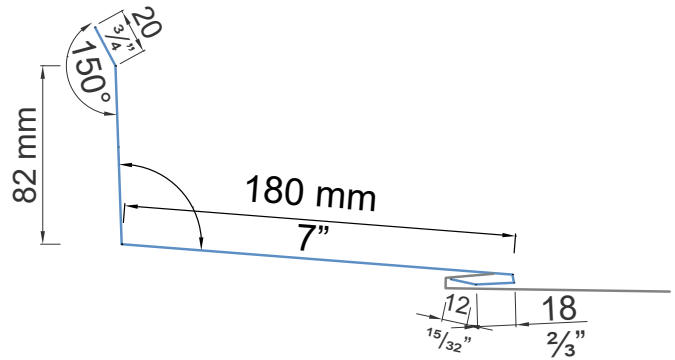
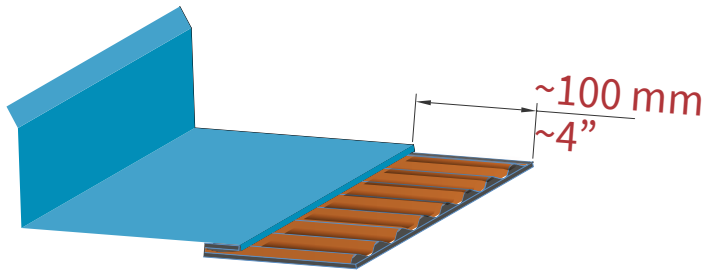

Plane trim for striated isoparete - Junta plana para Isoparete plissé

ISO L 52

External Pre-painting - Prepintado Externo

| Develop - Desarrollo | | Code - Código | Material |
|----------------------|-----------|---------------|---|
| 10" + 4¼" | 250 + 108 | ISO L 52 | Steel gauge 26 & 24 - Acero calibre 26 o 24 |
| inch | mm | | |

Linear working length 10 ft - Long. de trabajo 3.05 m lineales

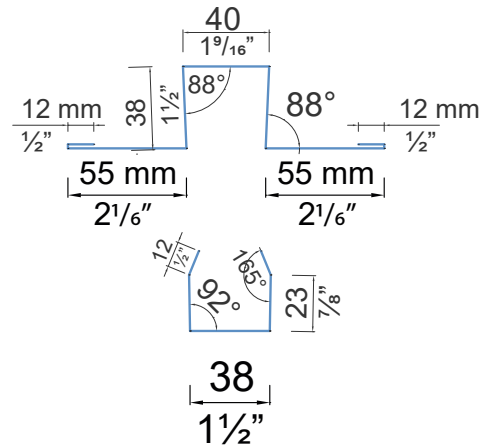
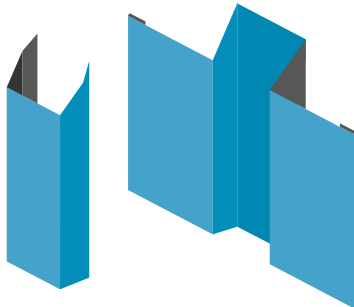

Trims - Molduras

Cover for all products - Tapa para todos los perfiles

ISO L 48

External Pre-painting - Repintado Externo

| Develop - Desarrollo | | Code - Código | Material |
|----------------------|-----|---------------|---|
| 12 1/4" | 312 | 1 | Steel gauge 26 & 24 - Acero calibre 26 o 24 |
| 12" | 308 | 2 | Steel gauge 26 & 24 - Acero calibre 26 o 24 |
| 16 1/3" | 416 | 3 | Steel gauge 26 & 24 - Acero calibre 26 o 24 |

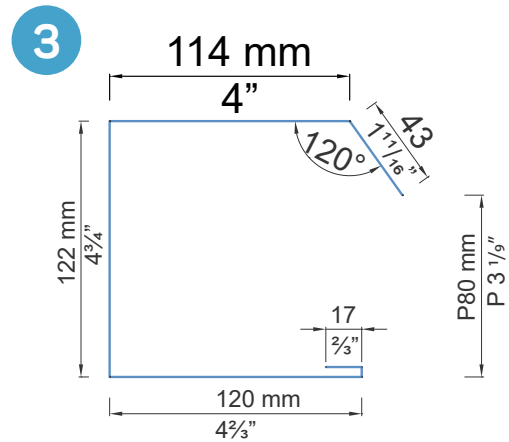
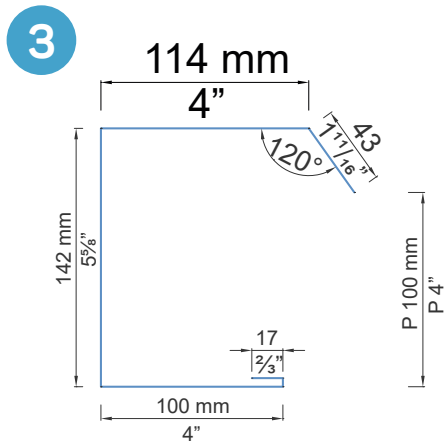
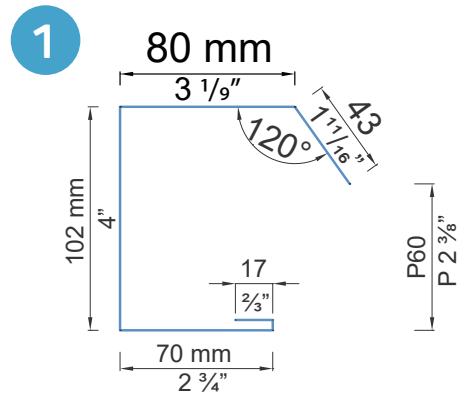
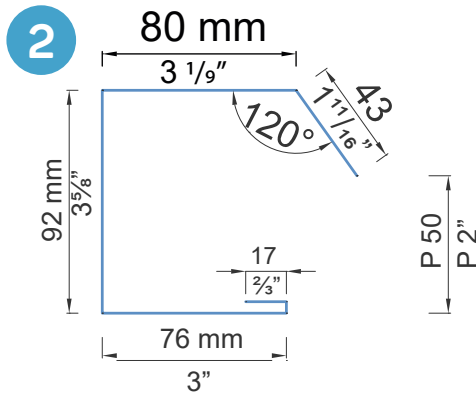
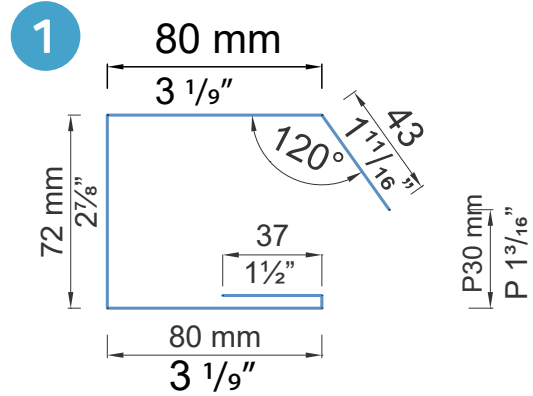
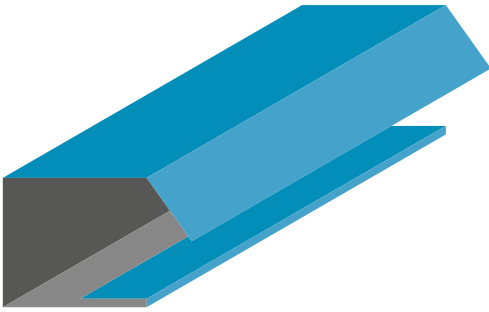

Trims - Molduras

Omega trim and flashing for all isoparete panel - Junta omega y tapajuntas para todos los paneles isoparete

ISO L 53

External Pre-painting - Prepintado Externo

| Develop - Desarrollo | | Code - Código | Material |
|----------------------|-----------|---------------|---|
| 12 ¼" + 5 ⅝" | 312 + 142 | ISO L 53 | Steel gauge 26 & 24 - Acero calibre 26 o 24 |
| inch | mm | | |

Linear working length 10 ft - Long. de trabajo 3.05 m lineales

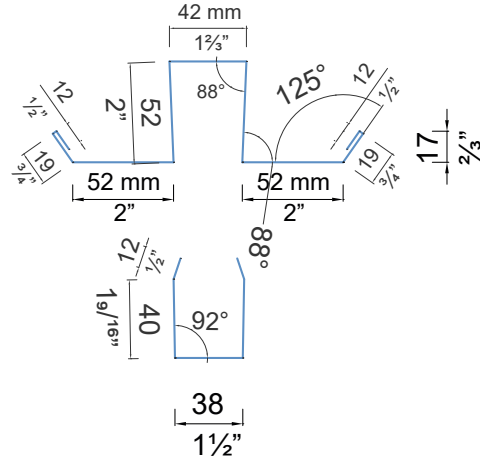
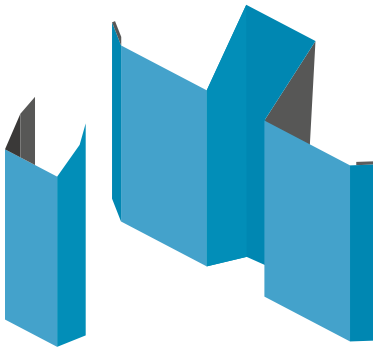

Ventilated ridge cap for roof - Moldura ventilada para juntas inferiores techo / muro
Junta plana para Isoparete plissé - Plane joint for striated Isoparete

ISO L 54

External Pre-painting - Prepintado Externo

| Develop - Desarrollo | | Code - Código | Material |
|----------------------|-----------|---------------|---|
| 12 ¼" + 9 ¼" | 312 + 235 | ISO L 54 | Steel gauge 26 & 24 - Acero calibre 26 o 24 |
| inch | mm | | |

Linear working length 10 ft - Long. de trabajo 3.05 m lineales

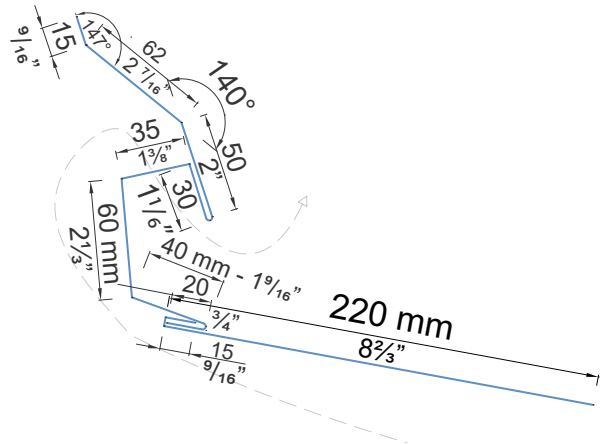
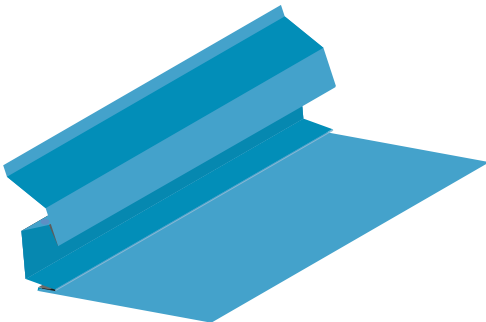

Trims - Molduras

Ventilated ridge cap for roof / wall - Moldura ventilada para juntas inferiores techo / muro

ISO L54 PIANO

External Pre-painting - Prepintado Externo

| Develop - Desarrollo | | Code - Código | Material |
|----------------------|-----------|----------------|---|
| 12 1/4" + 10" | 312 + 250 | ISO L 54 PIANO | Steel gauge 26 & 24 - Acero calibre 26 o 24 |
| inch | mm | | |

Linear working length 10 ft - Long. de trabajo 3.05 m lineales

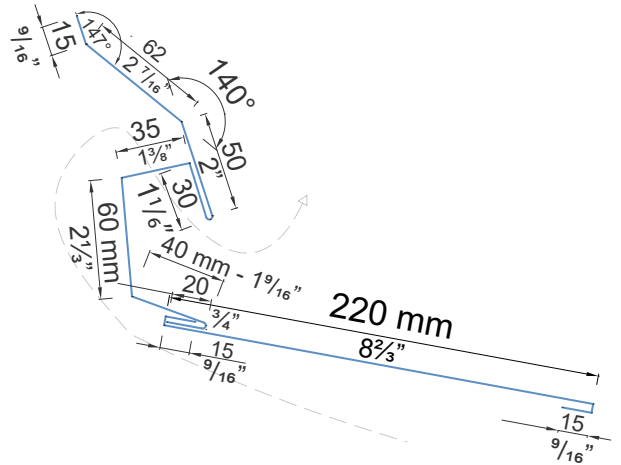
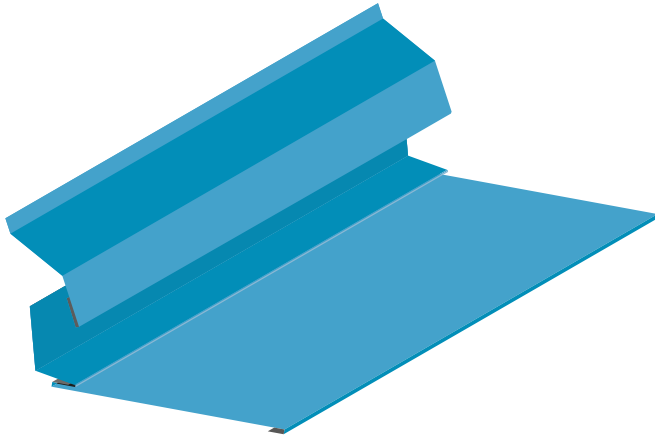



isocindú

BUILDING ENVELOPE SOLUTIONS
Cindú - Manni Group J.V.

ISOCINDU MÉXICO

Av. Libre Comercio #137
Puerto Interior Santa Fe III
Silao Gto. C.P. 36275
T. +52 472 800 7241

MANNI GREEN TECH USA

179 Hughes Landing Blvd
Suite 400, The woodlands TX
TX 77398
T. (281) 747-5588

MANNI GREEN TECH USA

77530 Enfield Lane,
Building D, Suite D2,
Palm Desert, California, 92211
T. (281) 747-5588

ISOPAN IBERICA
Terragona | Spain

ITALY
ISOPAN SPA
Verona | Italy
Frosinone | Italy

ISOPAN EST
Popești Leordeni | Romania

ISOPAN Manni Group CZ
Praha | Czech Republic

ISOPAN FRANCE
Mérignac | France



www.isocindú.com / atencionaclientes@isocindú.mx