

Isoparete Plus-2

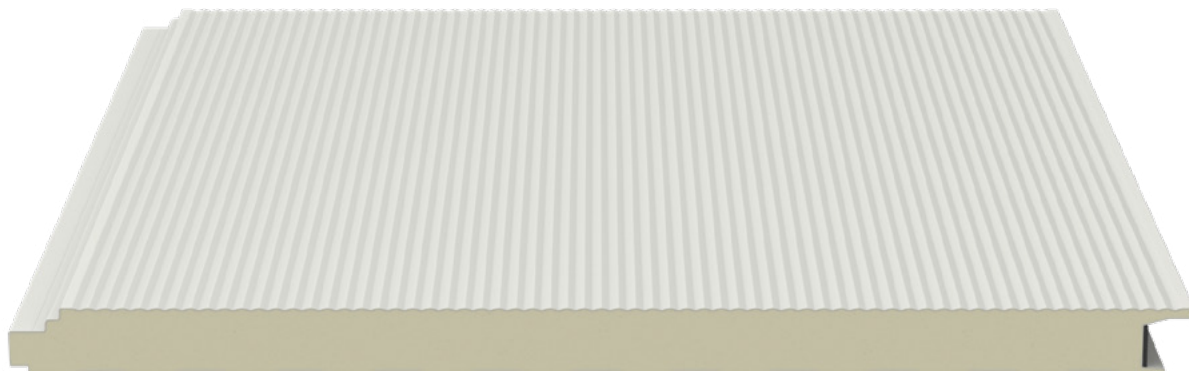

Product Description

- Sandwich panel for external and internal walls
- Double metal facing in pre-painted sheet metal
- Configurable aesthetic profiling
- Polyurethane foam insulation
- Interlocking system with concealed fastening

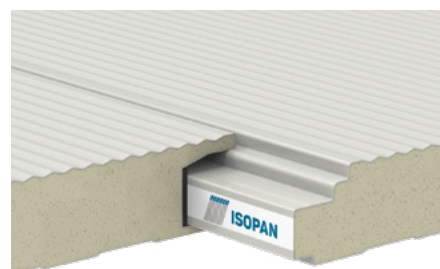

Profilature

PLISSÉ / LU



FLAT / PE

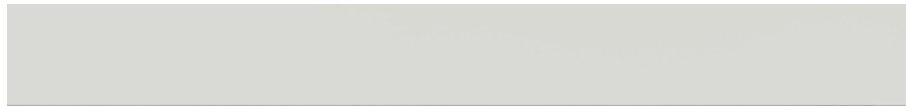

BOX / PG



DOUBLE / RO



MICRORIGA 500mm / DT



DIAMOND



EMERALD



Graphic Guidelines

The profiling images shown in this catalog are rendered for illustrative purposes only and may not accurately reflect the actual proportions and characteristics of the product.



Isoparete Plus-2

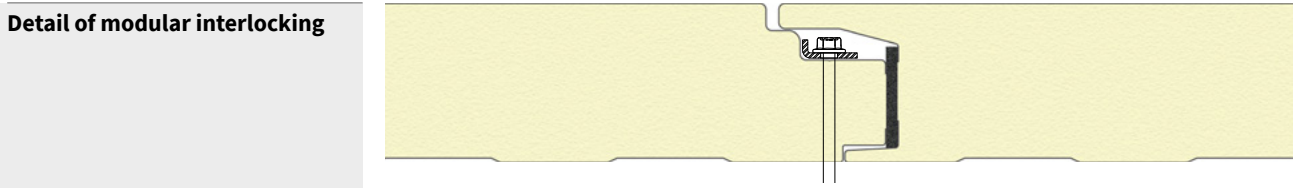
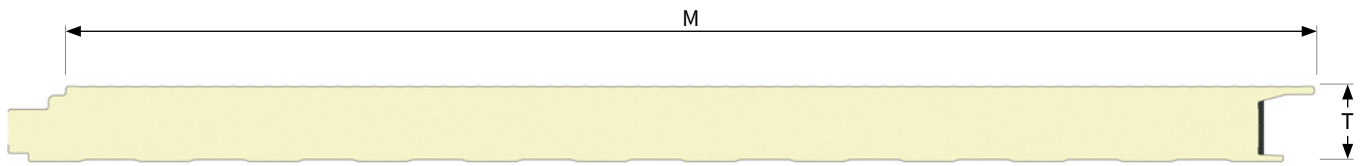

Useful width - "M"	1000 mm
---------------------------	---------

Available length	On request
-------------------------	------------

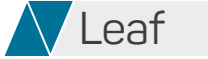
Insulation	Polyurethane foam (PU), Polyisocyanurate foam (PIR) Nominal density 40 kg/m ³ Available with LEAF insulation	
-------------------	---	---

Facing materials	External metal sheet: Pre-painted sheet Internal metal sheet: Pre-painted sheet
-------------------------	--

Fire Performance Any fire performance must be specifically requested when ordering. For more technical information, please contact Isopan	Reaction to fire (EN 13501-1; EN 13509) Up to B,s1-d0 (PIR, LEAF)	Fire resistance (EN 13501-2; EN 14509) EI 30 - PIR 100mm EI 20* - PIR 80mm *with assembly instructions
---	---	--

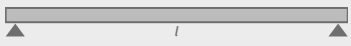

Capacity tables
Steel sheets
Sheet thickness
0,5mm - External
0,5mm - Internal
Support width 120mm

UNIFORMLY DISTRIBUTED LOAD [kg/m ²]	 NOMINAL SHEET THICKNESS [mm]					
	40	50	60	80	100	120
	Maximum Span "l" [cm]					
50	320	380	440	550	640	730
60	300	350	410	500	590	680
80	260	310	350	440	520	600
100	230	275	320	395	470	540
120	210	250	290	360	430	490
140	190	230	265	330	395	455
160	175	210	245	310	370	425
180	165	195	230	290	345	400
200	155	185	215	270	325	375

Capacity tables
Steel sheets
Sheet thickness
0,5mm - External
0,5mm - Internal
Support width 120mm

Calculation for static dimensioning carried out according to the contents of Annex E of EN standard 14509. Deflection limit 1/200 ℓ. The values shown in the capacity tables do not take into account the thermal load.

UNIFORMLY DISTRIBUTED LOAD [kg/m ²]	 NOMINAL SHEET THICKNESS [mm]					
	40	50	60	80	100	120
	Maximum Span "l" [cm]					
50	380	450	520	650	740	800
60	340	410	470	590	660	710
80	290	350	410	500	550	600
100	260	310	360	440	490	510
120	230	280	320	390	430	460
140	200	250	295	360	390	420
160	185	220	265	330	360	385
180	160	200	240	305	340	360
200	145	180	215	285	315	335

Technical specifications
Available thickness 'T'
Thermal insulation 'U' according to EN 14509 - A.10. The weight considers panels with steel sheets, nominal thickness indicated in the table.

T [mm]	Thermal Insulation - U			[Kg/m ²]	
	[W/m ² K]	[kcal/m ² h °C]		0,5mm	0,6mm
40	0,64		0,55	9,8	11,5
50	0,49		0,42	10,2	11,9
60	0,37	0,31	0,32	10,6	12,3
80	0,28	0,23	0,24	11,4	13,1
100	0,22	0,18	0,19	12,2	13,9
120	0,19	0,15	0,16	13,0	14,7

Instructions for use and dimensional tolerances

consult the Technical Manual, General Sales Conditions and Annexes available on the website.