

Isofire Wall MB Fono

Product Description

- Sandwich panel for external and internal walls
- Double metal facing in pre-painted sheet metal
- Microperforated inner sheet for improved soundproofing performance
- Mineral wool insulation

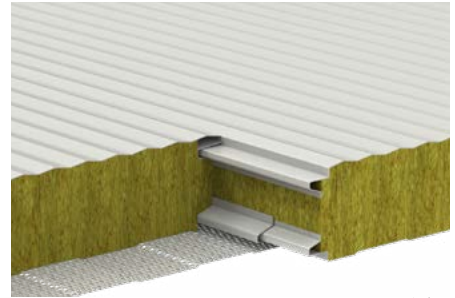

M

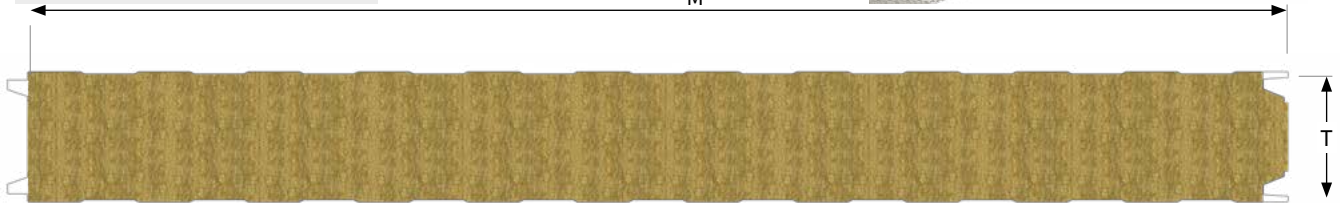

Detail of modular interlocking

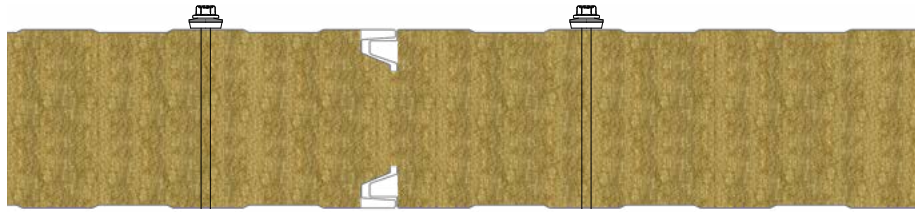

Useful width - "M"

1000 mm

Available length

On request

Insulation

Rock fibre mineral wool feldspatica
Nominal density 100 kg/m³

Metal sheets

External metal sheet: Pre-painted sheet
Internal metal sheet: Pre-painted sheet microforata

Acoustic Performance

Any acoustic performance must be specifically requested when ordering. For more technical information, please contact Isopan.

ACOUSTIC INSULATION RW

36 dB (120mm)
34 dB (100mm)
33 dB (50mm)

SOUND ABSORPTION $\alpha_W = 1$

50 - 200mm

Fire Performance

Any fire performance must be specifically requested when ordering. For more technical information, please contact Isopan.

Reaction to fire (EN 13501-1)

Up to A2-s1,d0

Fire resistance (EN 13501-2)

EI 60 - 100mm



Capacity tables

Steel sheets
Sheet thickness
0,5 mm - External
0,6 mm - Internal

Support width 120mm

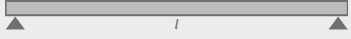
UNIFORMLY DISTRIBUTED LOAD [kg/m ²]	 NOMINAL SHEET THICKNESS [mm]					
	50	60	80	100	120	150
	Maximum Span "l" [cm]					
50	370	400	450	510	560	635
60	325	360	415	475	525	585
80	260	295	355	420	460	515
100	210	245	305	370	410	460
120	175	210	265	320	365	415
140	150	175	230	285	325	370
160	130	155	205	250	290	335
180	120	135	185	225	265	300
200	105	125	170	210	245	275

Capacity tables

Steel sheets
Sheet thickness
0,5 mm - External
0,6 mm - Internal

Support width 120mm

UNIFORMLY DISTRIBUTED LOAD [kg/m ²]	 NOMINAL SHEET THICKNESS [mm]					
	50	60	80	100	120	150
	Maximum Span "l" [cm]					
50	325	350	385	420	455	485
60	290	320	345	375	410	435
80	225	260	290	310	335	355
100	175	210	240	260	280	295
120	150	170	200	220	240	255
140	130	145	175	190	210	220
160	105	130	155	170	185	190
180	100	110	135	150	160	170
200	90	100	125	135	150	160

Calculation for static dimensioning carried out according to the contents of Annex E of EN standard 14509. Deflection limit 1/200 ℓ. The values shown in the capacity tables do not take into account the thermal load.

Technical specifications Available thickness 'T'

Thermal Transmittance 'U' according to EN 14509 - A.10. The weight considers panels with steel sheets, nominal thickness indicated in the table.

T [mm]	Thermal Transmittance - U		Weight - [Kg/m ²]	
	[W/m ² K]	[kcal/m ² h °C]	0,5 + 0,6 mm	0,6 + 0,6 mm
50	0,75	0,65	12,6	13,5
60	0,63	0,54	13,6	14,5
80	0,49	0,42	15,6	16,5
100	0,39	0,34	17,6	18,5
120	0,33	0,28	19,6	20,5
150	0,27	0,23	22,6	23,5

Instructions for use and dimensional tolerances

consult the Technical Manual, General Sales Conditions and Annexes available on the website.